

RUNWAY DATA TABLE				
	RUNWAY 9		RUNWAY 27	
	EXISTING	FUTURE	EXISTING	FUTURE
RUNWAY DESIGN CODE (RDC)	C-III-5000	SAME	C-III-VIS	SAME
APPROACH REFERENCE CODE (APRC)	D/IV/5000 D/V/5000	SAME	D/IV/VIS D/V/VIS	SAME
DEPARTURE REFERENCE CODE (DPRC)	D/IV D/V	SAME	D/IV D/V	SAME
PAVEMENT SURFACE	ASPHALT	SAME	ASPHALT	SAME
SURFACE TREATMENT	GROOVED	SAME	GROOVED	SAME
PAVEMENT STRENGTH - WHEEL LOADING (POUNDS)	SW 45,000 DW 89,000	SAME	45,000 89,000	SAME
PAVEMENT STRENGTH - PCN	35/F/D/X/T	SAME	35/F/D/X/T	SAME
RUNWAY GRADIENT	0.4% ³	SAME	0.4% ³	SAME
PERCENT WIND COVERAGE (ALL WEATHER)	10.5 KNOTS 97.77% 13 KNOTS 98.79% 16 KNOTS 99.57%	SAME	97.77% 98.79% 99.57%	SAME
RUNWAY LENGTH	7,111'	SAME	7,111'	SAME
RUNWAY WIDTH	100'	SAME	100'	SAME
RUNWAY END - COORDINATES (NAD 83)	LAT. 37° 57' 22.76" LONG. 107° 55' 14.35"	SAME	37° 57' 04.68" 107° 53' 48.59"	SAME
RUNWAY END - ELEVATION (NAVD 88)	9038.1'	SAME	9069.7'	SAME
DISPLACED THRESHOLD - LENGTH	200'	SAME	200'	SAME
DISPLACED THRESHOLD - COORDINATES (NAD 83)	LAT. 37° 57' 22.25" LONG. 107° 55' 11.94"	SAME	37° 57' 06.19" 107° 53' 51.00"	SAME
DISPLACED THRESHOLD - ELEVATION (NAVD 88)	9036.7'	SAME	9068.1'	SAME
RUNWAY LIGHTING	HIRL	SAME	HIRL	SAME
RUNWAY PROTECTION ZONE (RPZ)	600x1,700x1,010'	SAME	600x1,700x1,010'	SAME
RUNWAY MARKING	NON-PRECISION	SAME	NON-PRECISION	SAME
14 CFR PART 77 APPROACH CATEGORY	34:1	SAME	20:1	SAME
APPROACH TYPE	NON-PRECISION	SAME	VISUAL	SAME
VISIBILITY MINIMUMS	> 1 MILE	SAME	VISUAL	SAME
AERONAUTICAL SURVEY	VERTICALLY GUIDED	SAME	NON-VERTICALLY GUIDED	SAME
RUNWAY DEPARTURE SURFACE	YES	SAME	N/A	SAME
RUNWAY SAFETY AREA (RSA)	WIDTH 500' (500' STD.) LENGTH BEYOND DEPARTURE END 601' (1,000' STD.) ¹	SAME	500' (500' STD.) 601' (1,000' STD.) ¹	SAME
RUNWAY OBJECT FREE AREA (ROFA)	WIDTH 800' (800' STD.) LENGTH BEYOND RWY END 1,000' (1,000' STD.)	SAME	800' (800' STD.) 1,000' (1,000' STD.)	SAME
RUNWAY OBSTACLE FREE ZONE (ROFZ)	WIDTH 400' (400' STD.) LENGTH BEYOND RWY END 200' (200' STD.)	SAME	400' (400' STD.) 200' (200' STD.)	SAME
PRECISION OBSTACLE FREE ZONE (POFZ)	WIDTH N/A LENGTH BEYOND RWY END N/A	SAME	N/A N/A	SAME
THRESHOLD SITING SURFACE (TSS)	20:1 (TYPE 5) ²	SAME	20:1 (TYPE 3) ²	SAME
VISUAL AND INSTRUMENT NAVAIDS	LOC, DME, VOR/DME, RNAV (GPS), PAPI, REIL	SAME	VOR/DME, PAPI, REIL	SAME
TOUCHDOWN ZONE ELEVATION (NAVD 88)	9036.7'	SAME	9068.1'	SAME

1. ALL COORDINATES ARE IN NORTH AMERICAN DATUM OF 1983 (NAD 83)
2. ALL ELEVATIONS ARE IN NORTH AMERICAN VERTICAL DATUM OF 1989 (NAVD 88)
3. RUNWAY MEETS LINE OF SIGHT REQUIREMENT
4. THE FULL DIMENSION RSA REQUIREMENTS MET WITH 401' EMAS AND 200' DISPLACED THRESHOLD, PER AC 150/5300-13A, AIRPORT DESIGN, CHANGE 1.
5. PENETRATIONS LOCATED WITHIN RUNWAY 9 TSS
6. NO TSS PENETRATIONS FOR RUNWAY 27

AIRPORT DATA TABLE		
	EXISTING	FUTURE
AIRPORT REFERENCE CODE	C-II	C-III
MEAN MAXIMUM TEMPERATURE / HOTTEST MONTH	78° / JULY	SAME
AIRPORT ELEVATION (NAVD 88)	9069.7'	SAME
AIRPORT NAVIGATIONAL AIDS (OWNERSHIP)	VOR/DME (TEX), BEACON (TEX)	SAME
AIRPORT REFERENCE POINT (NAD 83)	LAT. 37° 57' 14" LONG. 107° 54' 32"	SAME
MISCELLANEOUS FACILITIES (OWNERSHIP)	SEGMENTED CIRCLE W/ LIGHTED, LOCALIZER (FAA) WINDCONE (TEX), AWOS-3 (TEX)	SAME
AIRPORT REFERENCE CODE AND CRITICAL AIRCRAFT	C-III / G550	C-II / G500-G7
MAGNETIC VARIATION	9° 37' WEST 0° 6' FEBRUARY 2016	SAME
NPIAS SERVICE LEVEL	NON-PRIMARY / COMMERCIAL SERVICE	SAME
STATE EQUIVALENT SERVICE ROLE	COMMERCIAL SERVICE	SAME

1. ALL COORDINATES ARE IN NORTH AMERICAN DATUM OF 1983 (NAD 83)
2. ALL ELEVATIONS / VERTICAL CONTROL DATUM ARE IN NAVD 88 AND EXPRESSED IN FEET ABOVE MEAN SEA LEVEL (MSL).
3. MAGNETIC VARIATION SOURCE: NOAA NATIONAL CENTERS FOR ENVIRONMENTAL INFORMATION, WORLD MAGNETIC MODEL (WMM) (2014-2019)

MODIFICATION TO STANDARDS			
APPROVAL DATE	AIRSPACE CASE NO.	STANDARD TO BE MODIFIED	DESCRIPTION
N/A	N/A	N/A	N/A



DATA SOURCE: NOAA NATIONAL CLIMATIC DATA CENTER
STATION: TELLURIDE REGIONAL AIRPORT - AWOS
DATA RANGE: 2006 - 2015

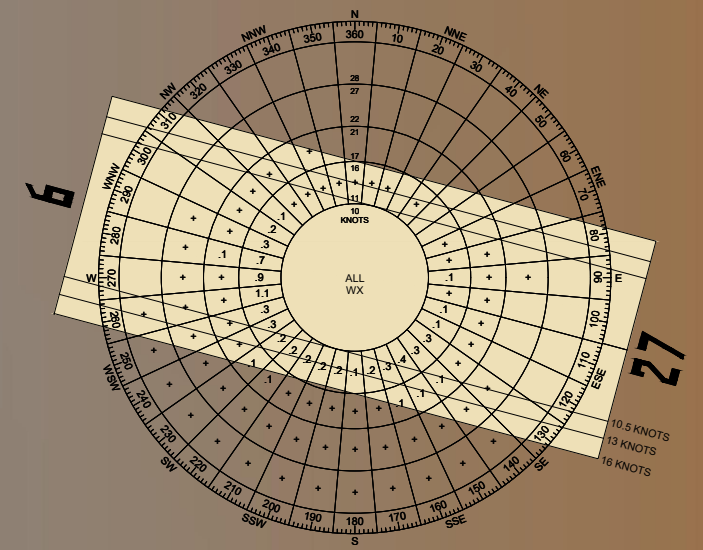

ALL WEATHER WIND DATA			
RUNWAY	10.5 KNOTS	13 KNOTS	16 KNOTS
RUNWAY 9-27	97.77%	98.79%	99.57%

ALL WEATHER OBSERVATIONS: 214,850

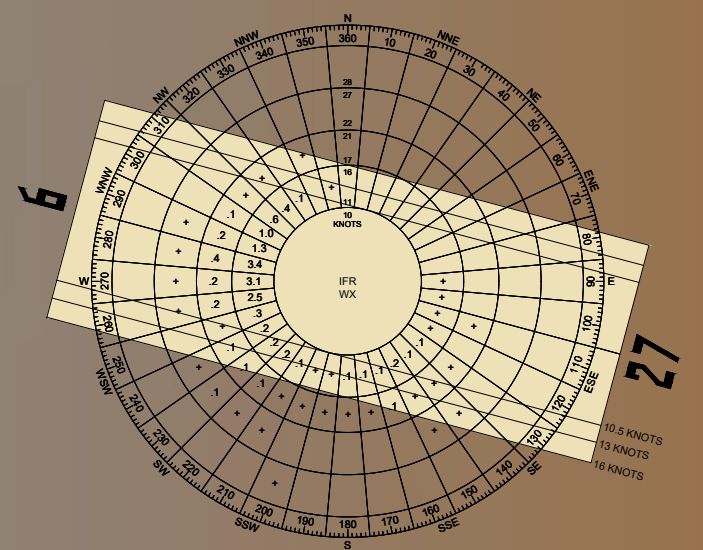

IFR WIND DATA			
RUNWAY	10.5 KNOTS	13 KNOTS	16 KNOTS
RUNWAY 9-27	98.55%	98.09%	98.55%

IFR OBSERVATIONS: 10,925

TAXIWAY / TAXILANE DATA TABLE									
	TWY A	TWY A2 (F)	TWY A3	TWY A3 (F)	TWY A4	TWY A4 (F)	T/L B2 (F)	TWY B2 (F)	TWY B3 (F)
TAXIWAY / TAXILANE WIDTH	50' (TDG 4)	35' (TDG 2)	70' (TDG 4)	50' (TDG 4)	70' (TDG 4)	50' (TDG 4)	35' (TDG 2)	35' (TDG 2)	35' (TDG 2)
TAXIWAY EDGE SAFETY MARGIN	10'	7.5'	10'	10'	10'	10'	7.5'	7.5'	7.5'
TAXIWAY / TAXILANE SAFETY AREA	118' (ADG III)	118' (ADG III)	118' (ADG III)	118' (ADG III)	118' (ADG III)	118' (ADG III)	118' (ADG III)	118' (ADG III)	118' (ADG III)
TAXIWAY / TAXILANE SEPARATION (OBJECTS WITHIN TSA)	MEETS STANDARDS	MEETS STANDARD	MEETS STANDARDS	MEETS STANDARDS	MEETS STANDARDS	MEETS STANDARDS	MEETS STANDARD	MEETS STANDARD	MEETS STANDARD
TAXIWAY / TAXILANE OBJECT FREE AREA	186' (ADG II)	186' (ADG II)	186' (ADG II)	186' (ADG II)	186' (ADG II)	186' (ADG II)	162' (ADG III)	186' (ADG III)	186' (ADG III)
TAXIWAY / TAXILANE SEPARATION (OBJECTS WITHIN TOFA)	MEETS STANDARDS	MEETS STANDARD	MEETS STANDARDS	MEETS STANDARDS	MEETS ROAD 69' EAST	MEETS ROAD 69' EAST	MEETS STANDARD	MEETS STANDARD	MEETS STANDARD
TAXIWAY / TAXILANE LIGHTING	MITL	MITL	MITL	MITL	MITL	MITL	MITL	MIRL	MITL

1. TAXIWAY DESIGN GROUP SHOWN IS LARGEST GROUP ALLOWABLE FOR TAXIWAY WIDTH

DECLARED DISTANCES				
RUNWAY END	TORA	TODA	ASDA	LDA
RUNWAY 9	EXISTING	7,111'	7,111'	7,111'
	FUTURE	7,111'	7,111'	7,111'
RUNWAY 27	EXISTING	7,111'	7,111'	7,111'
	FUTURE	7,111'	7,111'	7,111'

SURVEY MONUMENTS					
IDENTIFIER	NGS PID	PACS OR SACS	LATITUDE	LONGITUDE	ELEVATION
TEX E	DP6810	PACS	37° 57' 13.233"	107° 54' 16.624"	9043.9'
TEX F	DP6811	SACS	37° 57' 22.805"	107° 54' 58.980"	9024.6'
TEX G	DP6812	SACS	37° 57' 07.899"	107° 53' 50.179"	9063.2'

SOURCE: NATIONAL GEODETIC SURVEY, NAD 83 (2011), NAVD 88



SPONSOR APPROVAL

TELLURIDE REGIONAL AIRPORT AUTHORITY:

DATED: _____

AIP PROJECT NUMBER: 3-08-0088-038
REV.: _____

JACOBS PROJECT NUMBER: WXYB3300
DATE: 11/01/24

DESIGNED: DCC
DRAWN: DCC
CHECKED: JP
APPROVED: JAR

DRAWING PATHNAME: _____

REFERENCE DRAWING PATHNAME: _____

ISSUE RECORD				
NO.	BY	DATE	DESCRIPTION	CKD

FAA CONDITIONAL APPROVAL

SUBJECT TO LETTER DATED: _____

FEDERAL AVIATION ADMINISTRATION

DATED: _____

CASE NO: _____

AIRPORT BUILDING/FACILITY LIST (E)

NO.	DESCRIPTION	TOP ELEV.
1	TERMINAL BUILDING	9084.8'
2	FUEL STORAGE	9079.5'
3	EXECUTIVE HANGAR	9082.1'
4	EXECUTIVE HANGAR	9080.3'
5	HANGAR (S1-S3) 180' X 60'	9086.1'
6	CONVENTIONAL HANGAR	9116.0'
7	DEICING PAD	N/A
8	AIRPORT MAINTENANCE HANGAR	9076.9'
9	AIRCRAFT RESCUE FIRE FIGHTING (ARFF) STORAGE	9082.1'
10	SEGMENTED WIND CONE WITH LIGHTED WINDCONE	9079.3'
11	REMOTE COMMUNICATION OUTLET (RCO)	9138.8'
12	EXECUTIVE HANGAR (185' X 50')	9085.0'
13	CONVENTIONAL HANGAR (146' X 120')	9105.3'
14	WATER STORAGE TANK	9123.1'
15	FUEL TRUCK SHADE	9078.0'
16	FUEL FARM	9076.1'
17	AIRPORT ROTATING BEACON	9091.7'
18	SELF FUELING FACILITY	9076.1'
19	AWOS	9052.0'
20	LOCALIZER SHELTER	9043.0'

AIRPORT BUILDING/FACILITY LIST (F)

NO.	DESCRIPTION	TOP ELEV.
21	TERMINAL BUILDING	N/A
22	NEW HANGAR	N/A
23	CAMPUS WATER/FIRE/GEN PUMP	N/A
24	NEW HANGAR AUTO PARKING	N/A
25	RENTAL CAR STORAGE BUILDING	N/A
26	RENTAL CAR RETURN	N/A
27	SURFACE AUTO PARKING	N/A
28	SURFACE AUTO PARKING	N/A
29	RENTAL CAR QTA SERVICE AND STORAGE	N/A
30	RENTAL CAR STORAGE BUILDING	N/A
31	SNOW STORAGE AND DRAINAGE	N/A
32	FBO TERMINAL	N/A
33	ARFF/Mx BUILDING	N/A

LEGEND

	EXISTING	FUTURE
AIRPORT PROPERTY LINE		
EASEMENTS		
AIRFIELD PAVEMENT		
BUILDINGS		
BUILDING RESTRICTION LINES	B.R.L.	
RUNWAY SAFETY AREA	RSA	RSA
RUNWAY OBJECT FREE AREA	OFA	OFA
RUNWAY PROTECTION ZONE	RPZ	RPZ
TAXIWAY SAFETY AREA	TSA	TSA
TAXIWAY OBJECT FREE AREA	TOFA	TOFA
PRECISION OBJECT FREE ZONE		
NAVAID CRITICAL AREA		
SECTION CORNER		
ROADS AND PARKING AREAS		
GROUND CONTOURS		
PONDS, LAKES, STREAMS, ETC		
FENCE LINE		
AIRPORT BEACON		
AIRPORT REFERENCE POINT		
SEGMENTED CIRCLE & WIND CONE		
SUPPLEMENTAL WIND CONE		
REIL		
PAPI		
POWER POLE		
SURVEY CONTROL POINT		

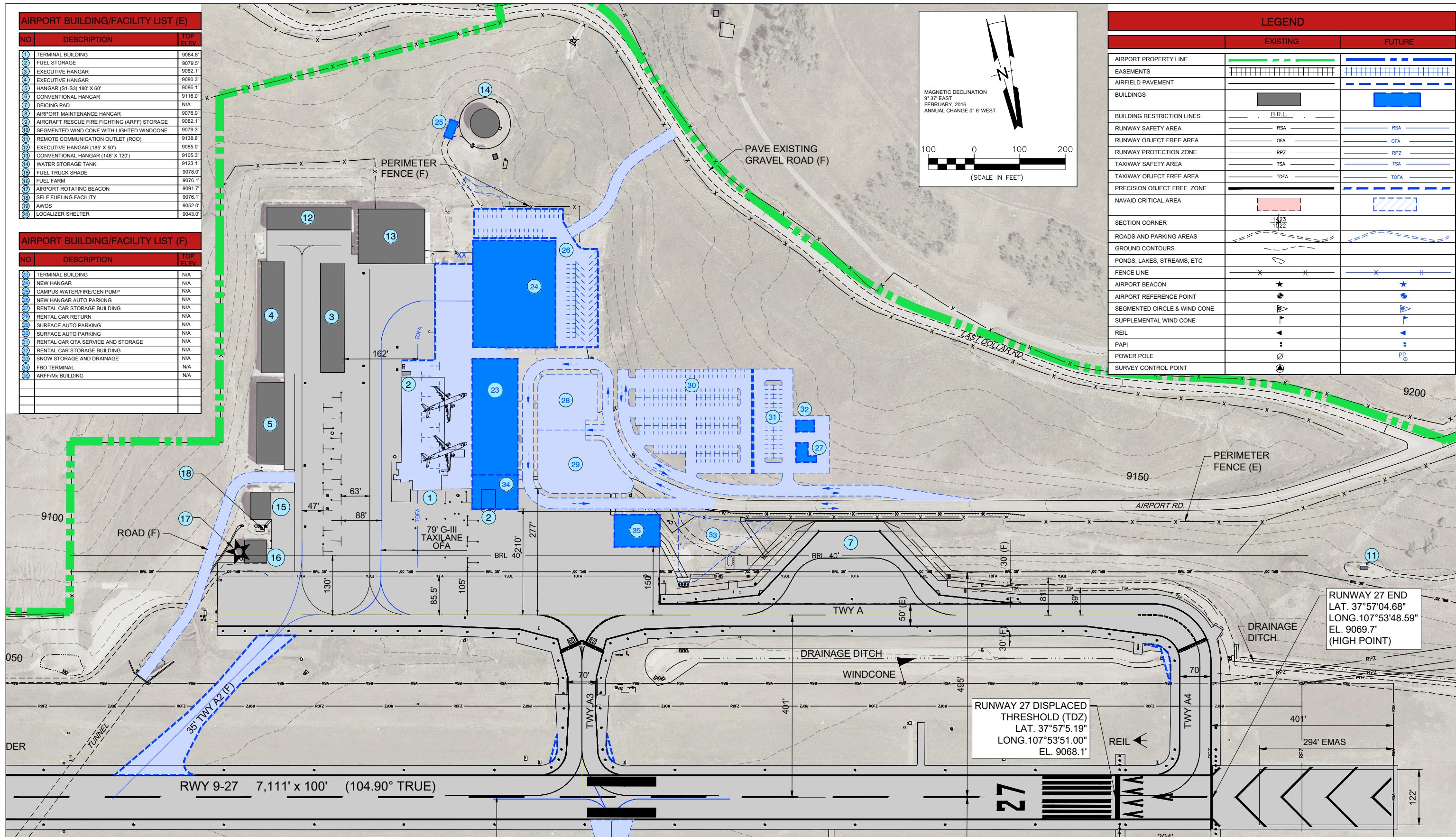
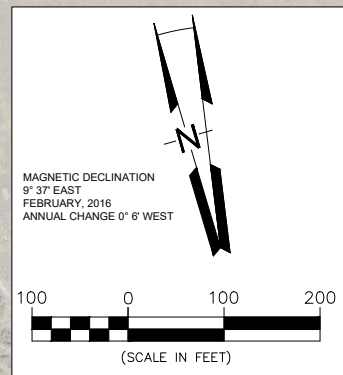

RUNWAY 27 END
LAT. 37°57'04.68"
LONG. 107°53'48.59"
EL. 9069.7'
(HIGH POINT)

RUNWAY 27 DISPLACED
THRESHOLD (TDZ)
LAT. 37°57'5.19"
LONG. 107°53'51.00"
EL. 9068.1'

Jacobs
717 17th. STREET
SUITE 275
DENVER, COLORADO 80202

TELLURIDE
REGIONAL AIRPORT

SPONSOR APPROVAL

TELLURIDE REGIONAL AIRPORT AUTHORITY
DATED: _____

AIP PROJECT NUMBER:
3-08-0088-038
REV.:
JACOBS PROJECT NUMBER:
WXYB3300
DATE:
11/01/24
DESIGNED: DCC
DRAWN: DCC
CHECKED: JP
APPROVED: JAR
DRAWING PATHNAME:
REFERENCE DRAWING PATHNAME:

ISSUE RECORD

NO.	BY	DATE	DESCRIPTION	CKD

FAA CONDITIONAL APPROVAL
SUBJECT TO LETTER DATED: _____
FEDERAL AVIATION ADMINISTRATION
DATED: _____
CASE NO: _____

TERMINAL AREA LAYOUT PLAN
SHEET 4 OF 12 **DRAFT**

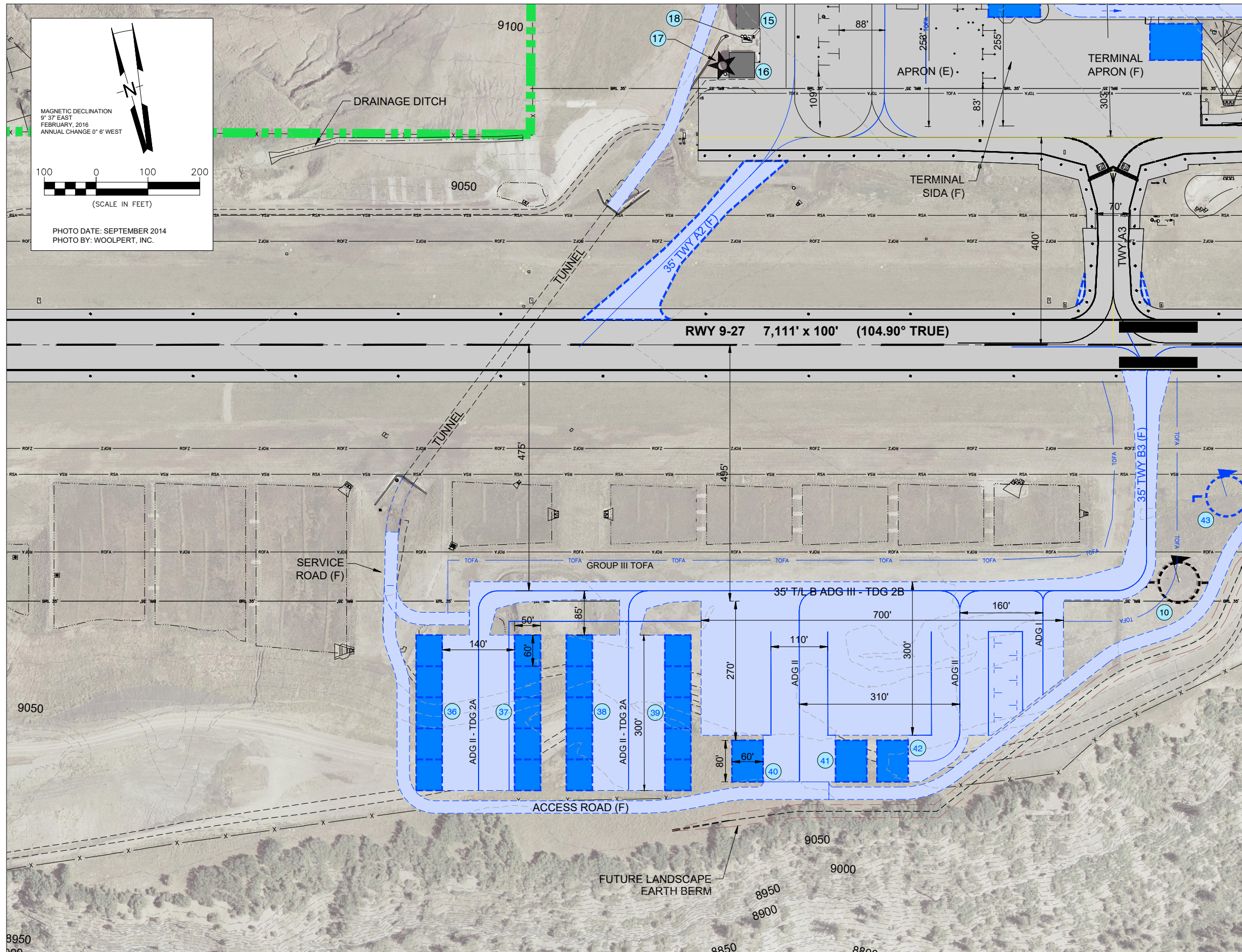

MAGNETIC DECLINATION
9° 37' EAST
FEBRUARY, 2016
ANNUAL CHANGE 0° 6' WEST

100 0 100 200
(SCALE IN FEET)

PHOTO DATE: SEPTEMBER 2014
PHOTO BY: WOOLPERT, INC.

LEGEND		
	EXISTING	FUTURE
AIRPORT PROPERTY LINE		
EASEMENTS		
AIRFIELD PAVEMENT		
BUILDINGS		
BUILDING RESTRICTION LINES	B.R.L.	
RUNWAY SAFETY AREA	RSA	RSA
RUNWAY OBJECT FREE AREA	OFA	OFA
RUNWAY PROTECTION ZONE	RPZ	RPZ
TAXIWAY SAFETY AREA	TSA	TSA
TAXIWAY OBJECT FREE AREA	TOFA	TOFA
PRECISION OBJECT FREE ZONE		
NAVAID CRITICAL AREA		
SECTION CORNER		
ROADS AND PARKING AREAS		
GROUND CONTOURS		
PONDS, LAKES, STREAMS, ETC		
FENCE LINE	X X	X X
AIRPORT BEACON		
AIRPORT REFERENCE POINT		
SEGMENTED CIRCLE & WIND CONE		
SUPPLEMENTAL WIND CONE		
REIL		
PAPI		
POWER POLE		
SURVEY CONTROL POINT		

AIRPORT BUILDING/FACILITY LIST (E)		
NO.	DESCRIPTION	TOP ELEV.
10	SEGMENTED CIRCLE WITH LIGHTED WINDCONE	9079.3'
15	FUEL TRUCK SHADE	9078.0'
16	FUEL FARM	9076.1'
17	AIRPORT ROTATING BEACON	9091.7'
18	SELF FUELING FACILITY	9076.1'

AIRPORT BUILDING/FACILITY LIST (F)		
NO.	DESCRIPTION	TOP ELEV.
36	BOX HANGARS	N/A
37	BOX HANGARS	N/A
38	BOX HANGARS	N/A
39	BOX HANGARS	N/A
40	PRIVATE HANGARS	N/A
41	PRIVATE HANGARS	N/A
42	PRIVATE HANGARS	N/A
43	SEGMENTED CIRCLE WITH LIGHTED WINDCONE	N/A
		N/A

Jacobs
717 17th. STREET
SUITE 275
DENVER, COLORADO 80202

TELLURIDE
REGIONAL AIRPORT

SPONSOR APPROVAL

TELLURIDE REGIONAL AIRPORT AUTHORITY:

DATED: _____

AIP PROJECT NUMBER:
3-08-0088-038

JACOBS PROJECT NUMBER:
WXYB3300

DESIGNED: DCC DRAWN: DCC CHECKED: JP APPROVED: JAR

DRAWING PATHNAME: _____

REFERENCE DRAWING PATHNAME: _____

ISSUE RECORD				
NO.	BY	DATE	DESCRIPTION	CKD

FAA CONDITIONAL APPROVAL

SUBJECT TO LETTER DATED: _____

FEDERAL AVIATION ADMINISTRATION

DATED: _____

CASE NO: _____

SOUTH GENERAL AVIATION AREA LAYOUT

SHEET 5 OF 12

DRAFT

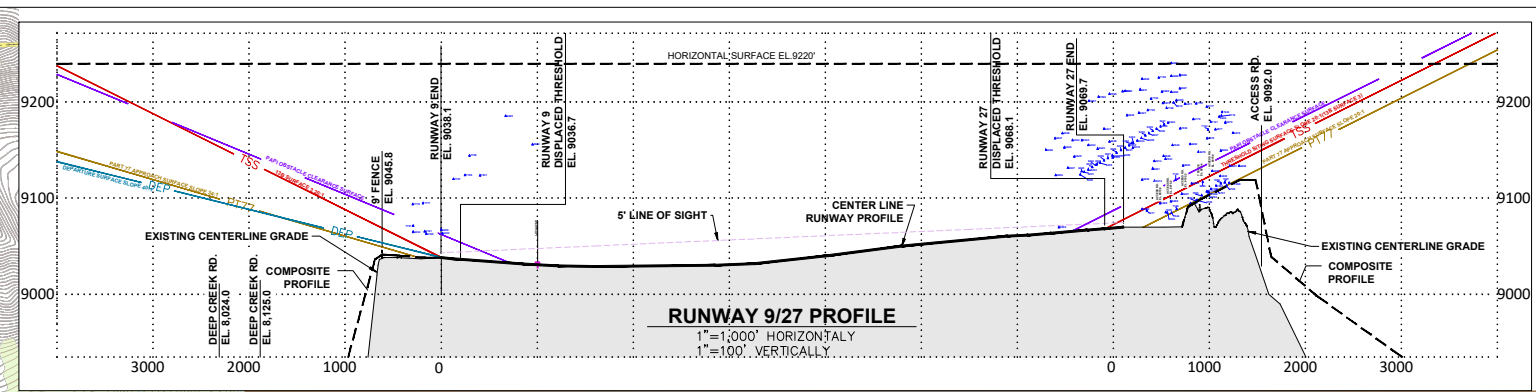
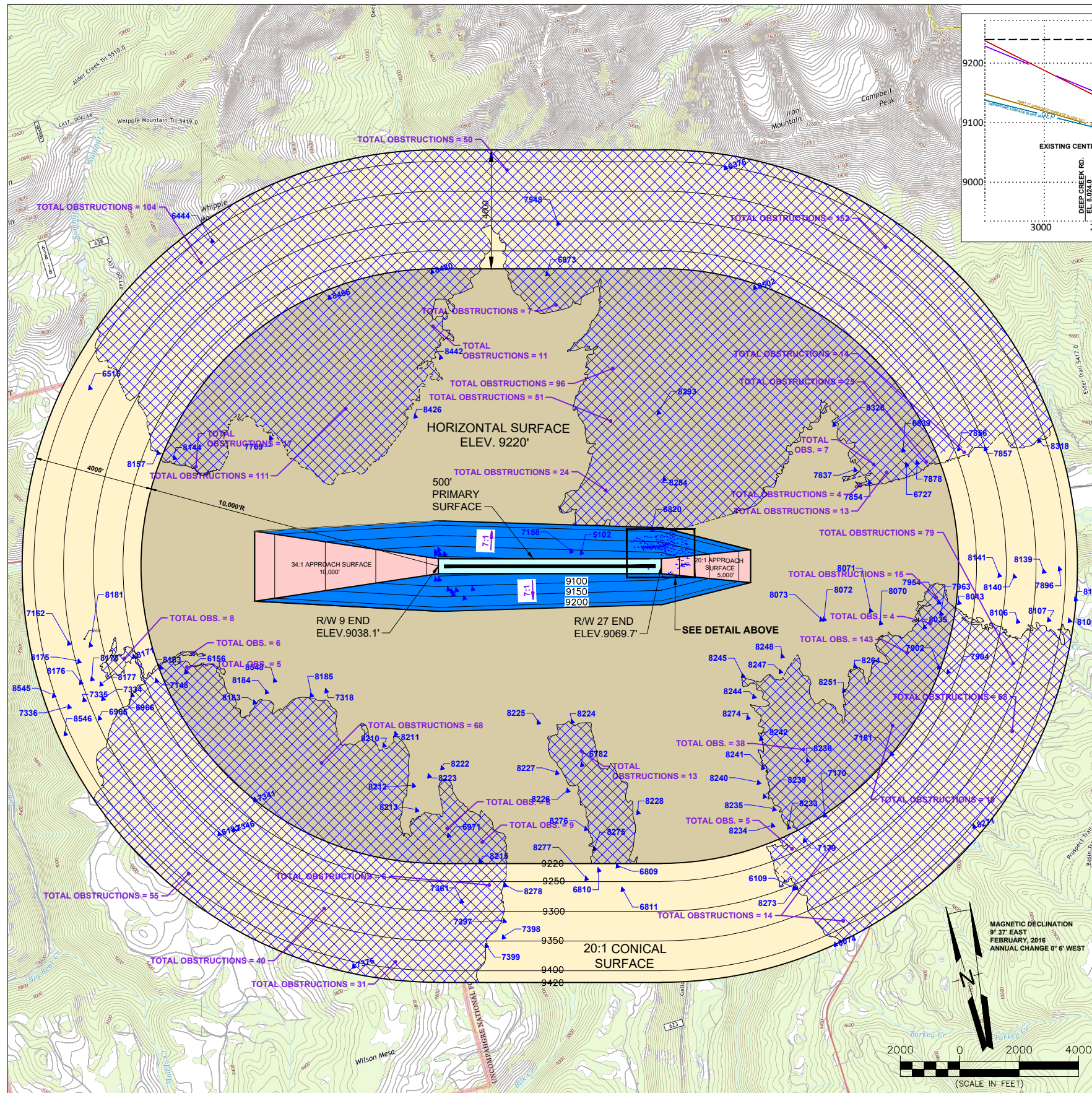

LEGEND	
DESCRIPTION	SYMBOL
OBSTRUCTION	▲ 5000
OBSTRUCTION GRID AREA	[Hatched Box]
ZONING RESTRICTIONS	
SEE SAN MIGUEL COUNTY LAND USE CODE, ARTICLE 5-STANDARDS, SECTION 5-418 TELLURIDE REGIONAL AIRPORT	

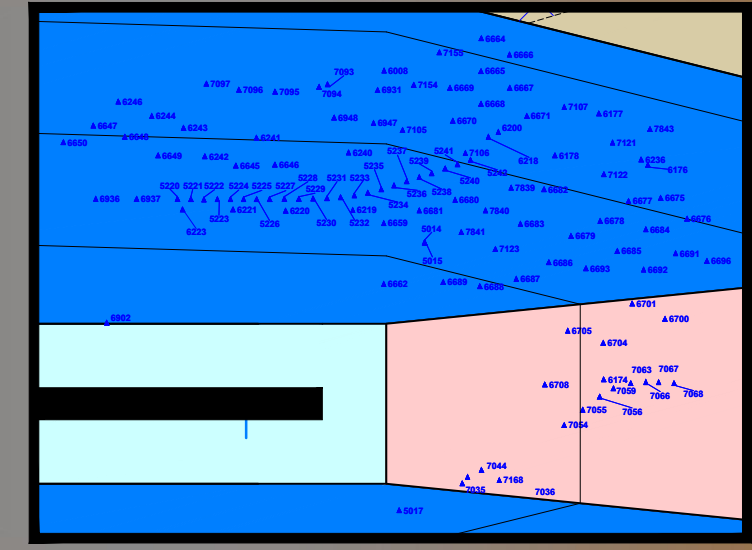

- A - UTILITY RUNWAYS
- B - RUNWAYS LARGER THAN UTILITY
- C - VISIBILITY MINIMUMS GREATER THAN 3/4 MILE
- D - VISIBILITY MINIMUMS AS LOW AS 3/4 MILE
- * - PRECISION INSTRUMENT APPROACH SLOPE IS 50:1 FOR INNER 10,000 FEET AND 40:1 FOR AN ADDITIONAL 40,000 FEET

DIM	ITEM	DIMENSIONAL STANDARDS (FEET)					
		VISUAL RUNWAY		NON-PRECISION INSTRUMENT RUNWAY		PRECISION INSTRUMENT RUNWAY	
		A	B	A	B	C	D
A	WIDTH OF PRIMARY SURFACE AND APPROACH SURFACE AT INNER END	250	500	500	500	1,000	1,000
B	RADIUS OF HORIZONTAL SURFACE	5,000	5,000	5,000	10,000	10,000	10,000
		VISUAL APPROACH		NON-PRECISION INSTRUMENT APPROACH		PRECISION INSTRUMENT RUNWAY	
		A	B	A	B	C	D
C	APPROACH SURFACE WIDTH AT END	1,250	1,500	2,000	3,500	4,000	16,000
D	APPROACH SURFACE LENGTH	5,000	5,000	5,000	10,000	10,000	*
E	APPROACH SLOPE	20:1	20:1	20:1	34:1	34:1	*

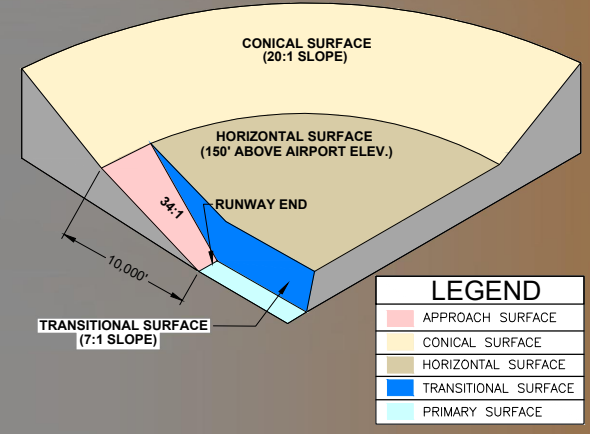

- GENERAL NOTES**
- OBSTRUCTIONS SHOWN WITHIN OBSTRUCTION GRID AREA ARE OBJECTS WITH THE HIGHEST PENETRATION AMOUNT FOR THAT AREA.
 - *TOTAL OBSTRUCTIONS = #H* REFERS TO THE TOTAL NUMBER OF OBSTRUCTIONS WITHIN THE HATCHED OBSTRUCTION GRID AREA.
 - SEE SHEET 7 FOR OBSTRUCTION TABLES.
 - SEE INNER APPROACH PLAN AND PROFILE SHEETS FOR CLOSE-IN OBSTRUCTIONS. (SHOWN AS SYMBOL ONLY)
 - USGS QUADRANGLE BASE MAPS OBTAINED NOVEMBER, 2014.

Jacobs
717 17th. STREET
SUITE 275
DENVER, COLORADO 80202

TELLURIDE
REGIONAL AIRPORT

SPONSOR APPROVAL

TELLURIDE REGIONAL AIRPORT AUTHORITY:
DATED: _____

AIP PROJECT NUMBER:
3-08-0088-038
REV.:
JACOBS PROJECT NUMBER:
WXYB3300
DATE:
11/01/24
DESIGNED: DCC
DRAWN: DCC
CHECKED: JP
APPROVED: JAR
DRAWING PATHNAME:
REFERENCE DRAWING PATHNAME:

ISSUE RECORD					
NO.	BY	DATE	DESCRIPTION	CKD	

FAA CONDITIONAL APPROVAL
SUBJECT TO LETTER DATED: _____
FEDERAL AVIATION ADMINISTRATION
DATED: _____
CASE NO: _____

AIRPORT AIRSPACE DRAWING
FAR PART 77 SURFACE
SHEET 6 OF 12 **DRAFT**

RUNWAY 27 OBSTRUCTION TABLE									
OBJECT NO.	OBJECT DESCRIPTION	ABOVE GROUND LEVEL (FT.)	OBJECT TOP ELEVATION (FT.)	CLEARANCE (+ PENETRATE) (- CLEAR)			PROPOSED DISPOSITION	PART 77 SURFACE VIOLATION	TRIGGERING EVENT
				PART 77 APPROACH SURFACE (FT.)	THRESHOLD SITING SURFACE (FT.)	PAPI OBSTACLE CLEARANCE SURFACE (FT.)			
5014	OL_ON ANTENNA	20.7	9138.8	28.6	N/A	N/A	FIXED BY FUNCTION	TRANSITIONAL	NONE
5015	GRND	0.0	9118.0	7.9	N/A	N/A	NO ACTION	TRANSITIONAL	NONE
5017	WSK	9.3	9087.3	4.3	N/A	N/A	FIXED BY FUNCTION	TRANSITIONAL	NONE
5220	CL_ROAD	0.0	9124.8	1.5	N/A	N/A	NO ACTION	TRANSITIONAL	NONE
5221	CL_ROAD	0.0	9127.4	3.9	N/A	N/A	NO ACTION	TRANSITIONAL	NONE
5222	CL_ROAD	0.0	9129.9	6.3	N/A	N/A	NO ACTION	TRANSITIONAL	NONE
5223	CL_ROAD	0.0	9132.4	8.6	N/A	N/A	NO ACTION	TRANSITIONAL	NONE
5224	CL_ROAD	0.0	9134.7	10.7	N/A	N/A	NO ACTION	TRANSITIONAL	NONE
5225	CL_ROAD	0.0	9137.0	12.8	N/A	N/A	NO ACTION	TRANSITIONAL	NONE
5226	CL_ROAD	0.0	9139.4	15.1	N/A	N/A	NO ACTION	TRANSITIONAL	NONE
5227	CL_ROAD	0.0	9141.8	17.3	N/A	N/A	NO ACTION	TRANSITIONAL	NONE
5228	CL_ROAD	0.0	9144.6	19.8	N/A	N/A	NO ACTION	TRANSITIONAL	NONE
5229	CL_ROAD	0.0	9147.3	22.2	N/A	N/A	NO ACTION	TRANSITIONAL	NONE
5230	CL_ROAD	0.0	9150.0	24.6	N/A	N/A	NO ACTION	TRANSITIONAL	NONE
5231	CL_ROAD	0.0	9152.6	26.9	N/A	N/A	NO ACTION	TRANSITIONAL	NONE
5232	CL_ROAD	0.0	9155.2	29.0	N/A	N/A	NO ACTION	TRANSITIONAL	NONE
5233	CL_ROAD	0.0	9157.6	30.7	N/A	N/A	NO ACTION	TRANSITIONAL	NONE
5234	CL_ROAD	0.0	9160.1	31.9	N/A	N/A	NO ACTION	TRANSITIONAL	NONE
5235	CL_ROAD	0.0	9162.7	33.0	N/A	N/A	NO ACTION	TRANSITIONAL	NONE
5236	CL_ROAD	0.0	9165.3	33.0	N/A	N/A	NO ACTION	TRANSITIONAL	NONE
5237	CL_ROAD	0.0	9167.8	32.3	N/A	N/A	NO ACTION	TRANSITIONAL	NONE
5238	CL_ROAD	0.0	9170.2	31.5	N/A	N/A	NO ACTION	TRANSITIONAL	NONE
5239	CL_ROAD	0.0	9172.5	30.6	N/A	N/A	NO ACTION	TRANSITIONAL	NONE
5240	CL_ROAD	0.0	9174.6	29.1	N/A	N/A	NO ACTION	TRANSITIONAL	NONE
5241	CL_ROAD	0.0	9176.7	27.9	N/A	N/A	NO ACTION	TRANSITIONAL	NONE
5242	CL_ROAD	0.0	9178.6	26.4	N/A	N/A	NO ACTION	TRANSITIONAL	NONE
6008	BUILDING	41.8	9224.4	41.8	N/A	N/A	NO ACTION	TRANSITIONAL	NONE
6174	FENCE	11.0	9107.2	3.5	-14.9	-28.7	NO ACTION	APPROACH	NONE
6176	FENCE	8.0	9186.0	16.3	N/A	N/A	NO ACTION	TRANSITIONAL	NONE
6177	FENCE	8.6	9195.5	8.2	N/A	N/A	NO ACTION	TRANSITIONAL	NONE
6178	FENCE	8.9	9182.3	18.7	N/A	N/A	NO ACTION	TRANSITIONAL	NONE
6200	FENCE	5.9	9202.0	34.3	N/A	N/A	NO ACTION	TRANSITIONAL	NONE
6218	FENCE	4.5	9199.7	35.2	N/A	N/A	NO ACTION	TRANSITIONAL	NONE
6219	FENCE	9.2	9152.6	32.2	N/A	N/A	NO ACTION	TRANSITIONAL	NONE
6220	FENCE	8.8	9142.3	22.6	N/A	N/A	NO ACTION	TRANSITIONAL	NONE
6221	FENCE	8.7	9135.5	16.1	N/A	N/A	NO ACTION	TRANSITIONAL	NONE
6223	FENCE	7.0	9128.0	9.3	N/A	N/A	NO ACTION	TRANSITIONAL	NONE
6236	FENCE	7.0	9185.0	13.5	N/A	N/A	NO ACTION	TRANSITIONAL	NONE
6240	GRND	0.0	9157.5	11.4	N/A	N/A	NO ACTION	TRANSITIONAL	NONE
6241	GRND	0.0	9172.3	20.8	N/A	N/A	NO ACTION	TRANSITIONAL	NONE
6242	GRND	0.0	9155.3	12.5	N/A	N/A	NO ACTION	TRANSITIONAL	NONE
6243	GRND	0.0	9180.4	5.2	N/A	N/A	NO ACTION	TRANSITIONAL	NONE
6244	GRND	0.0	9160.5	0.5	N/A	N/A	NO ACTION	TRANSITIONAL	NONE
6246	GRND	0.0	9167.7	1.8	N/A	N/A	NO ACTION	TRANSITIONAL	NONE
6645	GRND	0.0	9151.6	12.5	N/A	N/A	NO ACTION	TRANSITIONAL	NONE
6646	GRND	0.0	9159.2	19.2	N/A	N/A	NO ACTION	TRANSITIONAL	NONE
6647	GRND	0.0	9162.5	7.5	N/A	N/A	NO ACTION	TRANSITIONAL	NONE
6648	GRND	0.0	9152.9	2.6	N/A	N/A	NO ACTION	TRANSITIONAL	NONE
6649	GRND	0.0	9143.4	0.8	N/A	N/A	NO ACTION	TRANSITIONAL	NONE
6650	GRND	0.0	9150.4	3.3	N/A	N/A	NO ACTION	TRANSITIONAL	NONE
6659	GRND	0.0	9119.4	4.9	N/A	N/A	NO ACTION	TRANSITIONAL	NONE
6662	GRND	0.0	9088.8	1.4	N/A	N/A	NO ACTION	TRANSITIONAL	NONE
6664	GRND	0.0	9240.7	33.0	N/A	N/A	NO ACTION	TRANSITIONAL	NONE
6665	GRND	0.0	9227.4	34.5	N/A	N/A	NO ACTION	TRANSITIONAL	NONE
6666	GRND	0.0	9228.2	24.7	N/A	N/A	NO ACTION	TRANSITIONAL	NONE
6667	GRND	0.0	9214.3	25.5	N/A	N/A	NO ACTION	TRANSITIONAL	NONE
6668	GRND	0.0	9210.7	32.3	N/A	N/A	NO ACTION	TRANSITIONAL	NONE
6669	GRND	0.0	9211.1	29.1	N/A	N/A	NO ACTION	TRANSITIONAL	NONE
6670	GRND	0.0	9199.0	31.4	N/A	N/A	NO ACTION	TRANSITIONAL	NONE
6671	GRND	0.0	9198.3	20.3	N/A	N/A	NO ACTION	TRANSITIONAL	NONE
6675	GRND	0.0	9178.9	22.5	N/A	N/A	NO ACTION	TRANSITIONAL	NONE
6676	GRND	0.0	9168.1	17.9	N/A	N/A	NO ACTION	TRANSITIONAL	NONE
6677	GRND	0.0	9171.8	20.3	N/A	N/A	NO ACTION	TRANSITIONAL	NONE
6678	GRND	0.0	9162.3	22.9	N/A	N/A	NO ACTION	TRANSITIONAL	NONE
6679	GRND	0.0	9148.4	19.0	N/A	N/A	NO ACTION	TRANSITIONAL	NONE
6680	GRND	0.0	9144.2	11.5	N/A	N/A	NO ACTION	TRANSITIONAL	NONE
6681	GRND	0.0	9130.9	7.0	N/A	N/A	NO ACTION	TRANSITIONAL	NONE
6682	GRND	0.0	9156.4	9.1	N/A	N/A	NO ACTION	TRANSITIONAL	NONE
6683	GRND	0.0	9134.2	4.9	N/A	N/A	NO ACTION	TRANSITIONAL	NONE
6684	GRND	0.0	9149.6	8.8	N/A	N/A	NO ACTION	TRANSITIONAL	NONE
6685	GRND	0.0	9128.5	0.6	N/A	N/A	NO ACTION	TRANSITIONAL	NONE
6686	GRND	0.0	9115.5	0.3	N/A	N/A	NO ACTION	TRANSITIONAL	NONE
6687	GRND	0.0	9104.6	0.5	N/A	N/A	NO ACTION	TRANSITIONAL	NONE
6688	GRND	0.0	9096.8	0.0	N/A	N/A	NO ACTION	TRANSITIONAL	NONE
6689	GRND	0.0	9094.7	0.1	N/A	N/A	NO ACTION	TRANSITIONAL	NONE
6691	GRND	0.0	9133.8	0.4	N/A	N/A	NO ACTION	TRANSITIONAL	NONE
6692	GRND	0.0	9123.2	0.6	-5.1	N/A	NO ACTION	TRANSITIONAL	NONE
6693	GRND	0.0	9117.2	0.5	N/A	N/A	NO ACTION	TRANSITIONAL	NONE
6696	GRND	0.0	9133.8	0.4	-4.4	N/A	NO ACTION	TRANSITIONAL	NONE
6700	GRND	0.0	9113.4	0.2	-18.2	-31.9	NO ACTION	APPROACH	NONE
6701	GRND	0.0	9108.3	0.2	-18.2	N/A	NO ACTION	APPROACH	NONE
6704	GRND	0.0	9103.6	0.0	-18.4	-32.2	NO ACTION	APPROACH	NONE
6705	GRND	0.0	9098.1	0.1	-18.3	-32.2	NO ACTION	APPROACH	NONE
6708	GRND	0.0	9094.7	0.2	-18.2	-32.1	NO ACTION	APPROACH	NONE
6902	NAVAID	9.8	9069.9	2.8	N/A	N/A	FIXED BY FUNCTION	TRANSITIONAL	NONE
6931	PRKNG LOT	0.0	9213.2	39.3	N/A	N/A	NO ACTION	TRANSITIONAL	NONE
6936	ROAD	0.0	9124.2	1.9	N/A	N/A	NO ACTION	TRANSITIONAL	NONE
6937	ROAD	0.0	9131.8	9.0	N/A	N/A	NO ACTION	TRANSITIONAL	NONE
6947	ROAD	0.0	9189.0	29.8	N/A	N/A	NO ACTION	TRANSITIONAL	NONE
6948	ROAD	0.0	9186.5	24.9	N/A	N/A	NO ACTION	TRANSITIONAL	NONE

RUNWAY 27 OBSTRUCTION TABLE									
OBJECT NO.	OBJECT DESCRIPTION	ABOVE GROUND LEVEL (FT.)	OBJECT TOP ELEVATION (FT.)	CLEARANCE (+ PENETRATE) (- CLEAR)			PROPOSED DISPOSITION	PART 77 SURFACE VIOLATION	TRIGGERING EVENT
				PART 77 APPROACH SURFACE (FT.)	THRESHOLD SITING SURFACE (FT.)	PAPI OBSTACLE CLEARANCE SURFACE (FT.)			
7035	ROAD	0.0	9085.4	3.8	-14.6	N/A	NO ACTION	APPROACH	NONE
7036	ROAD	0.0	9085.2	2.8	-15.6	N/A	NO ACTION	APPROACH	NONE
7044	ROAD	0.0	9084.7	0.1	-18.3	N/A	NO ACTION	APPROACH	NONE
7054	ROAD	0.0	9097.7	0.2	-18.2	-32.0	NO ACTION	APPROACH	NONE
7055	ROAD	0.0	9103.2	2.8	-15.6	-29.4	NO ACTION	APPROACH	NONE
7056	ROAD	0.0	9107.2	4.2	-14.2	-28.0	NO ACTION	APPROACH	NONE
7059	ROAD	0.0	9109.8	4.6	-13.8	-27.6	NO ACTION	APPROACH	NONE
7063	ROAD	0.0	9113.1	5.2	-13.2	-26.9	NO ACTION	APPROACH	NONE
7066	ROAD	0.0	9115.6	5.4	-13.0	-26.8	NO ACTION	APPROACH	NONE
7067	ROAD	0.0	9116.6	4.4	-14.0	-27.8	NO ACTION	APPROACH	NONE
7068	ROAD	0.0	9116.0	1.3	-17.1	-30.8	NO ACTION	APPROACH	NONE
7093	ROAD	0.0	9211.8	35.3	N/A	N/A	NO ACTION	TRANSITIONAL	NONE
7094	ROAD	0.0	9211.5	36.2	N/A	N/A	NO ACTION	TRANSITIONAL	NONE
7095	ROAD	0.0	9208.8	36.2	N/A	N/A	NO ACTION	TRANSITIONAL	NONE
7096	ROAD	0.0	9205.6	32.6	N/A	N/A	NO ACTION	TRANSITIONAL	NONE
7097	ROAD	0.0	9201.3	26.1	N/A	N/A	NO ACTION	TRANSITIONAL	NONE
7105	ROAD	0.0	9191.7	33.8	N/A	N/A	NO ACTION	TRANSITIONAL	NONE
7106	ROAD	0.0	9194.1	39.4	N/A	N/A	NO ACTION	TRANSITIONAL	NONE
7107	ROAD	0.0	9198.7	12.5	N/A	N/A	NO ACTION	TRANSITIONAL	NONE
7121	ROAD	0.0	9179.8	4.1	N/A	N/A	NO ACTION	TRANSITIONAL	NONE
7122	ROAD	0.0	9171.3	10.7	N/A	N/A	NO ACTION	TRANSITIONAL	NONE
7123	ROAD	0.0	9119.1	3.9	N/A	N/A	NO ACTION	TRANSITIONAL	NONE
7154	DIRT TRAIL	0.0	9203.7	24.3	N/A	N/A	NO ACTION	TRANSITIONAL	NONE
7155	DIRT TRAIL	0.0	9225.6	28.9	N/A	N/A	NO ACTION	TRANSITIONAL	NONE
7168	TREE	34.5	9089.9	1.6	-16.9	N/A	TRIM	APPROACH	FY 2017
7839	TREE	12.7	9172.7	28.4	N/A	N/A	TRIM	TRANSITIONAL	FY 2017
7840	TREE	13.2	9155.4	24.1	N/A	N/A	TRIM	TRANSITIONAL	FY 2017
7841	TREE	12.9	9141.2	22.3	N/A	N/A	TRIM	TRANSITIONAL	FY 2017
7843	TREE	14.8	9189.7	3.7	N/A	N/A	TRIM	TRANSITIONAL	FY 2017

OBSTRUCTION TABLE							
OBJECT NO.	OBJECT DESCRIPTION	GROUND SURFACE ELEVATION (FT.) (2)	OBJECT TOP ELEVATION (FT.)	PART 77 SURFACE ELEVATION (FT.)	PART 77 CLEARANCE (+ PENETRATE) (- CLEAR)	PART 77 SURFACE VIOLATION	PROPOSED DISPOSITION
7902	TREE	9475.0	9636.1	9219.7	318.4	HORIZONTAL	NO ACTION
7904	TREE	9540.0	9606.4	9233.3	373.1	CONICAL	NO ACTION
7954	TREE	9302.0	9385.4	9219.7	145.7	HORIZONTAL	NO ACTION
7963	TREE	9273.0	9354.6	9219.7	134.9	HORIZONTAL	NO ACTION
8043	TREE	9188.0	9242.9	9223.7	19.2	CONICAL	NO ACTION
8070	TREE	9191.0	9235.7	9219.7	16.0	HORIZONTAL	NO ACTION
8071	TREE	9191.0	9251.1	9219.7	31.4	HORIZONTAL	NO ACTION
8072	TREE	9175.0	9223.8	9219.7	4.1	HORIZONTAL	NO ACTION
8073	TREE	9184.0	9222.4	9219.7	2.7	HORIZONTAL	NO ACTION
8101	TREE	9408.0	9473.3	9412.0	60.4	CONICAL	NO ACTION
8105	TREE	9417.0	9454.3	9418.4	36.0	CONICAL	NO ACTION
8108	TREE	9297.0	9353.8	9325.9	32.4	CONICAL	NO ACTION
8107	TREE	9304.0	9333.2	9377.2	16.0	CONICAL	NO ACTION
8139	TREE	9451.0	9472.2	9362.8	109.4	CONICAL	NO ACTION
8140	TREE	9381.0	9421.9	9313.5	108.4	CONICAL	NO ACTION
8141	TREE	9340.0	9398.8	9286.1	78.8	CONICAL	NO ACTION
8144	TREE	9308.0	9312.0	9219.7	92.3	HORIZONTAL	NO ACTION
8157	TREE	9273.0	9281.5	9226.7	52.8	CONICAL	NO ACTION
8163	TREE	9214.0	9280.0	9219.7	60.3	HORIZONTAL	NO ACTION
8171	TREE	9220.0	9308.6	9254.0	54.6	CONICAL	NO ACTION
8175	TREE	9301.0	9373.5	9345.1	28.4	CONICAL	NO ACTION
8176	TREE	9317.0	9357.7	9352.3	5.4	CONICAL	NO ACTION
8177	TREE	9295.0	9392.1	9320.7	41.4	CONICAL	NO ACTION
8178	TREE	9299.0	9347.6	9332.5	15.1	CONICAL	NO ACTION
8181	TREE	9253.0	9329.0	9320.0	9.1	CONICAL	NO ACTION
8183	TREE	9195.0	9306.0	9219.7	86.		

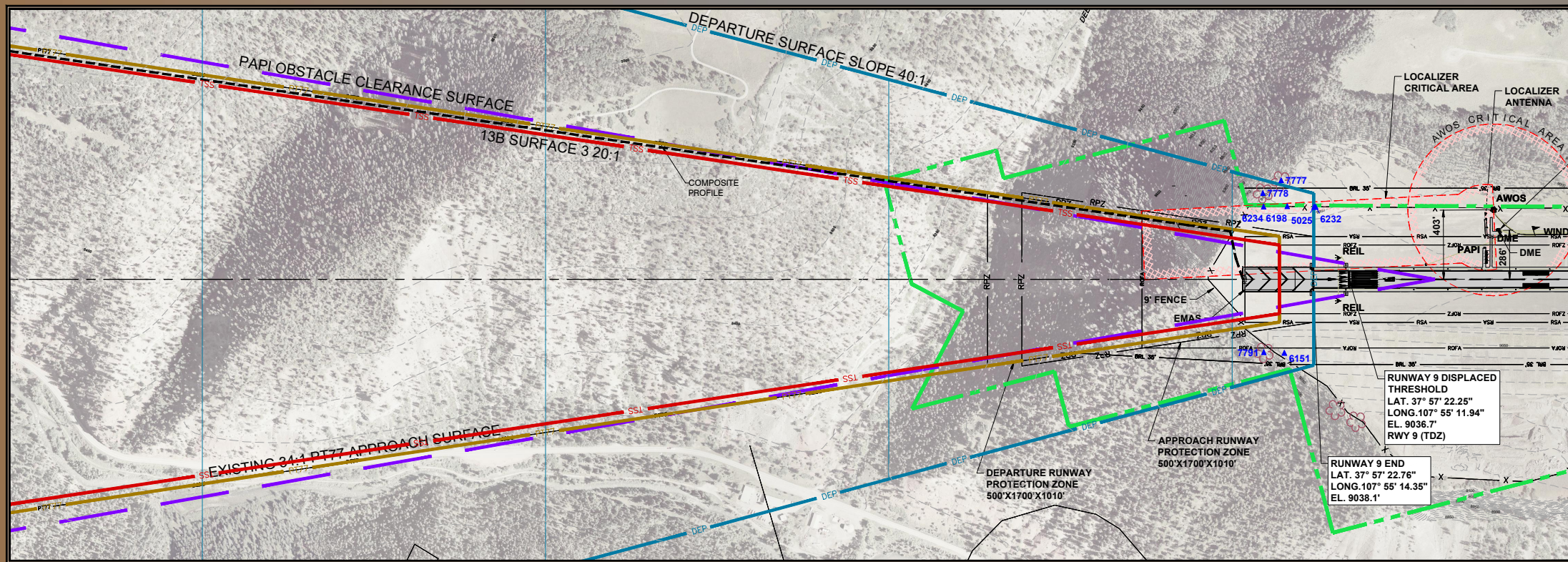

RUNWAY 9 PLAN VIEW

- NOTES:
 1. OBSTRUCTIONS SHOWN WITHIN OBSTRUCTION GRID AREA ARE OBJECTS WITH THE HIGHEST PENETRATION AMOUNT FOR THAT AREA.
 2. "TOTAL OBSTRUCTIONS = ##" REFERS TO THE TOTAL NUMBER OF OBSTRUCTIONS WITHIN THE HATCHED OBSTRUCTION GRID AREA.
 3. USGS QUADRANGLE BASE MAPS OBTAINED NOVEMBER, 2014.

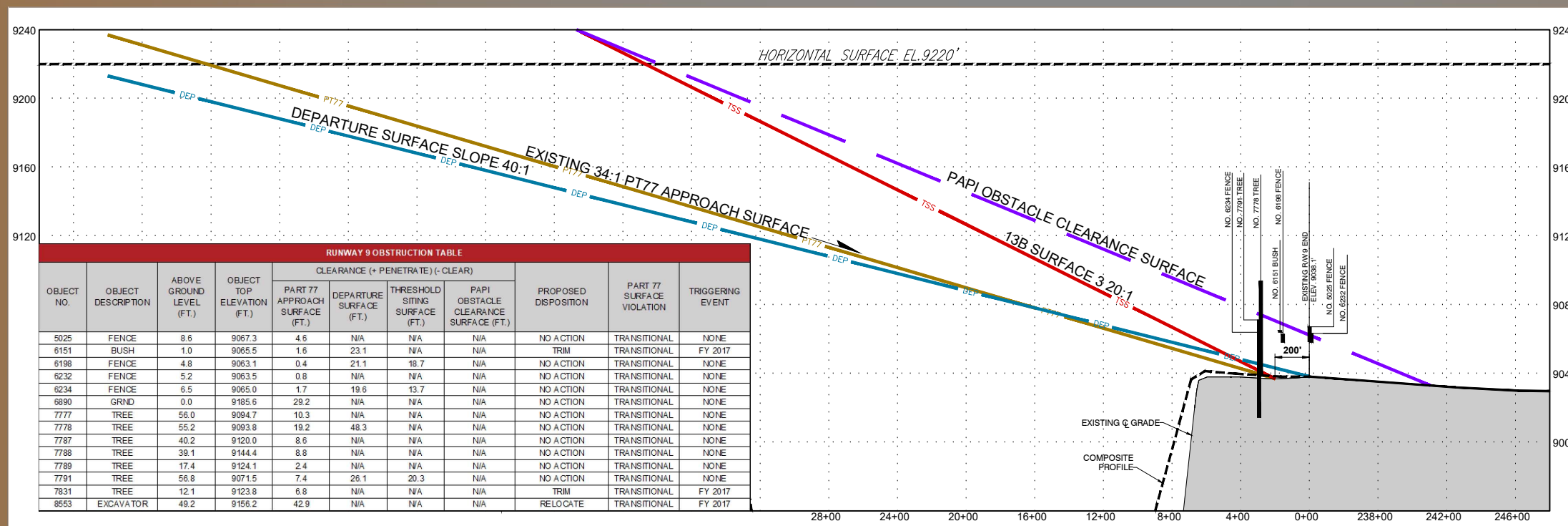
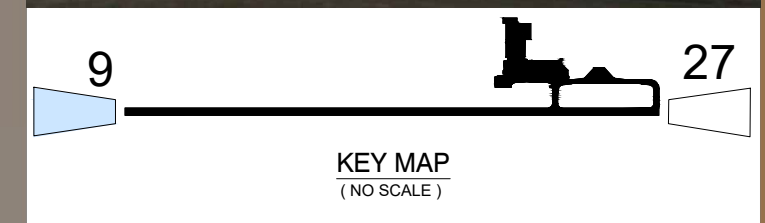

RUNWAY 9 PROFILE

RUNWAY 9 OBSTRUCTION TABLE										
OBJECT NO.	OBJECT DESCRIPTION	ABOVE GROUND LEVEL (FT.)	OBJECT TOP ELEVATION (FT.)	CLEARANCE (+ PENETRATE) (- CLEAR)			PROPOSED DISPOSITION	PART 77 SURFACE VIOLATION	TRIGGERING EVENT	
				PART 77 APPROACH SURFACE (FT.)	DEPARTURE SURFACE (FT.)	THRESHOLD SITING SURFACE (FT.)				PAPI OBSTACLE CLEARANCE SURFACE (FT.)
5025	FENCE	8.6	9067.3	4.6	N/A	N/A	N/A	NO ACTION	TRANSITIONAL	NONE
6151	BUSH	1.0	9065.5	1.6	23.1	N/A	N/A	TRIM	TRANSITIONAL	FY 2017
6198	FENCE	4.8	9063.1	0.4	21.1	18.7	N/A	NO ACTION	TRANSITIONAL	NONE
6232	FENCE	5.2	9063.5	0.8	N/A	N/A	N/A	NO ACTION	TRANSITIONAL	NONE
6234	FENCE	6.5	9065.0	1.7	19.6	13.7	N/A	NO ACTION	TRANSITIONAL	NONE
6890	GRND	0.0	9185.6	29.2	N/A	N/A	N/A	NO ACTION	TRANSITIONAL	NONE
7777	TREE	56.0	9094.7	10.3	N/A	N/A	N/A	NO ACTION	TRANSITIONAL	NONE
7778	TREE	55.2	9093.8	19.2	48.3	N/A	N/A	NO ACTION	TRANSITIONAL	NONE
7787	TREE	40.2	9120.0	8.6	N/A	N/A	N/A	NO ACTION	TRANSITIONAL	NONE
7788	TREE	39.1	9144.4	8.8	N/A	N/A	N/A	NO ACTION	TRANSITIONAL	NONE
7789	TREE	17.4	9124.1	2.4	N/A	N/A	N/A	NO ACTION	TRANSITIONAL	NONE
7791	TREE	56.8	9071.5	7.4	26.1	20.3	N/A	NO ACTION	TRANSITIONAL	NONE
7831	TREE	12.1	9123.8	6.8	N/A	N/A	N/A	TRIM	TRANSITIONAL	FY 2017
8553	EXCAVATOR	49.2	9156.2	42.9	N/A	N/A	N/A	RELOCATE	TRANSITIONAL	FY 2017

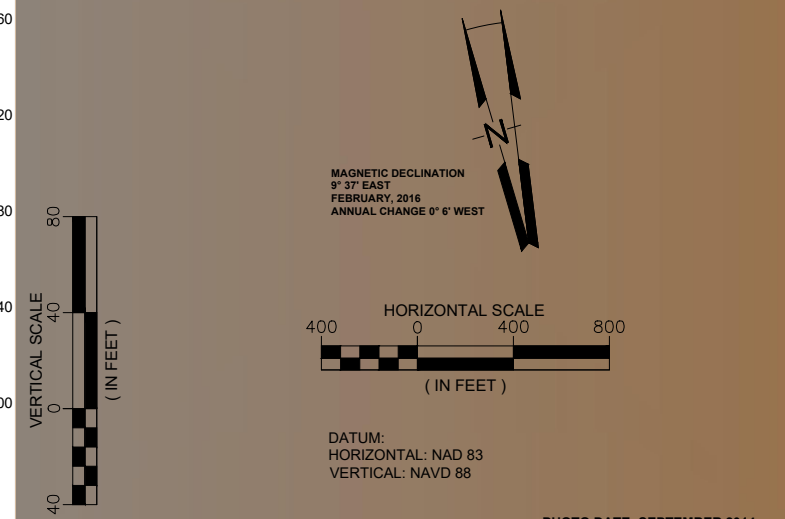

PHOTO DATE: SEPTEMBER 2014
 PHOTO BY: WOOLPERT, INC.

Jacobs
 717 17th. STREET
 SUITE 275
 DENVER, COLORADO 80202

TELLURIDE
 REGIONAL AIRPORT

SPONSOR APPROVAL

 TELLURIDE REGIONAL AIRPORT AUTHORITY
 DATED: _____

AIP PROJECT NUMBER:
 3-08-0088-038
 REV.:
 JACOBS PROJECT NUMBER:
 WXYB3300
 DATE:
 11/01/24
 DESIGNED: DCC
 DRAWN: DCC
 CHECKED: JP
 APPROVED: JAR
 DRAWING PATHNAME:
 REFERENCE DRAWING PATHNAME:

ISSUE RECORD				
NO.	BY	DATE	DESCRIPTION	CKD

FAA CONDITIONAL APPROVAL
 SUBJECT TO LETTER DATED: _____
 FEDERAL AVIATION ADMINISTRATION
 DATED: _____
 CASE NO: _____

INNER APPROACH
 PLAN AND PROFILE
 RUNWAY 9
 SHEET 8 OF 12
DRAFT

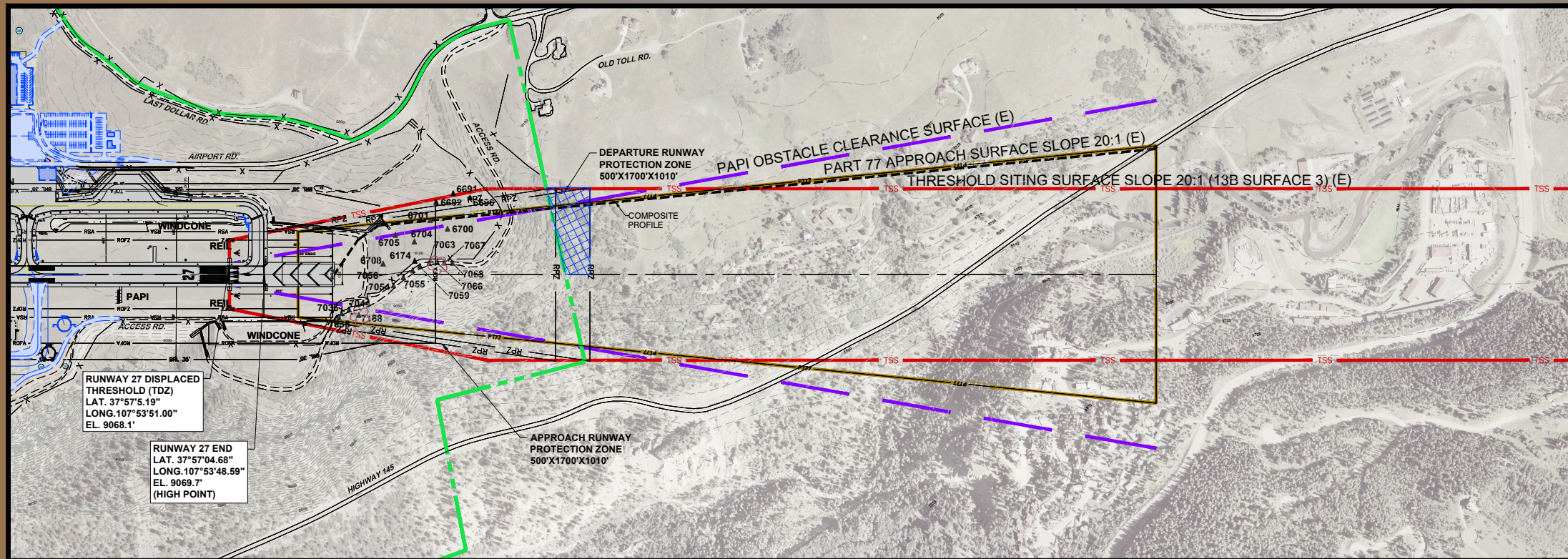

RUNWAY 27 PLAN VIEW

NOTE:
1. SEE SHEET 7 FOR OBSTRUCTION TABLES.

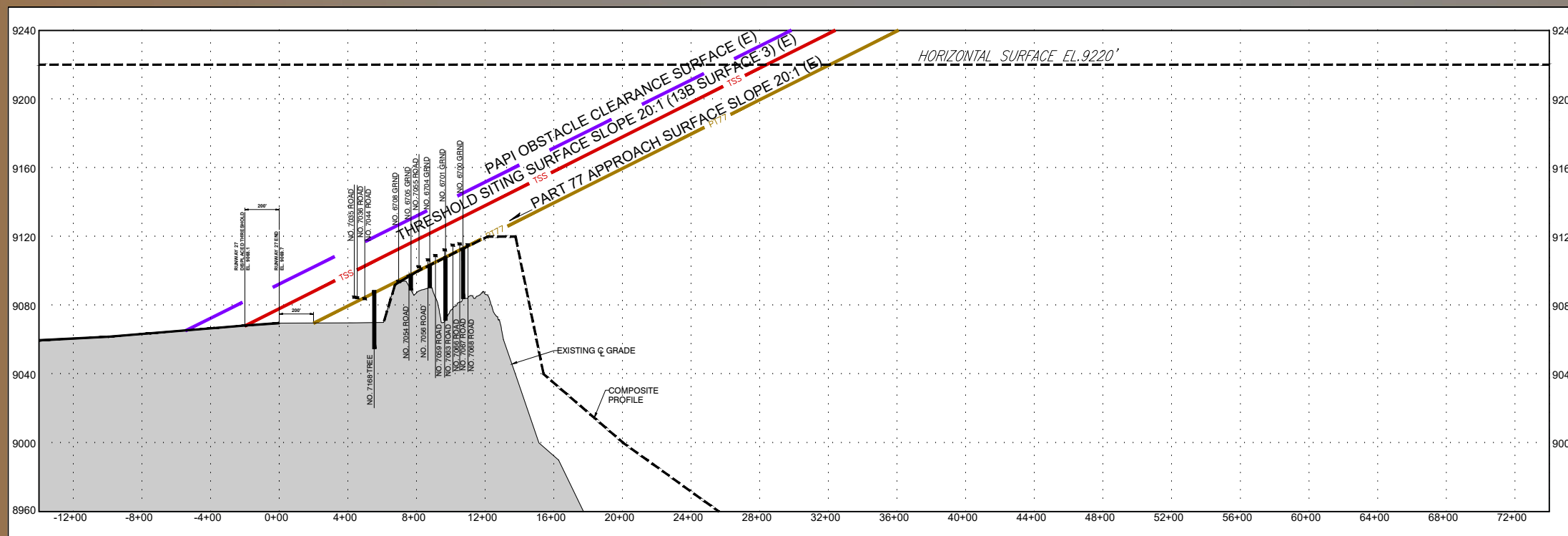
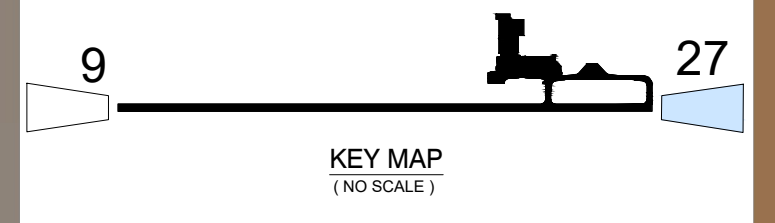

RUNWAY 27 PROFILE

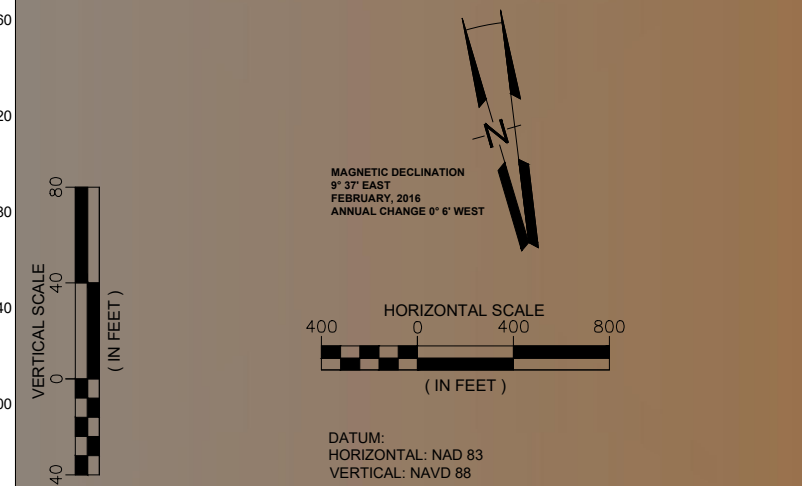

PHOTO DATE: SEPTEMBER 2014
PHOTO BY: WOOLPERT, INC.

Jacobs
717 17th. STREET
SUITE 275
DENVER, COLORADO 80202



SPONSOR APPROVAL

TELLURIDE REGIONAL AIRPORT AUTHORITY:

DATED: _____

AIP PROJECT NUMBER: 3-08-0088-038		REV.:	
JACOBS PROJECT NUMBER: WXYB3300		DATE: 11/01/24	
DESIGNED: DCC	DRAWN: DCC	CHECKED: JP	APPROVED: JAR
DRAWING PATHNAME:			
REFERENCE DRAWING PATHNAME:			

ISSUE RECORD				
NO.	BY	DATE	DESCRIPTION	CKD

FAA CONDITIONAL APPROVAL

SUBJECT TO LETTER DATED: _____

FEDERAL AVIATION ADMINISTRATION

DATED: _____

CASE NO: _____

INNER APPROACH
PLAN AND PROFILE
RUNWAY 27

SHEET 9 OF 12

DRAFT

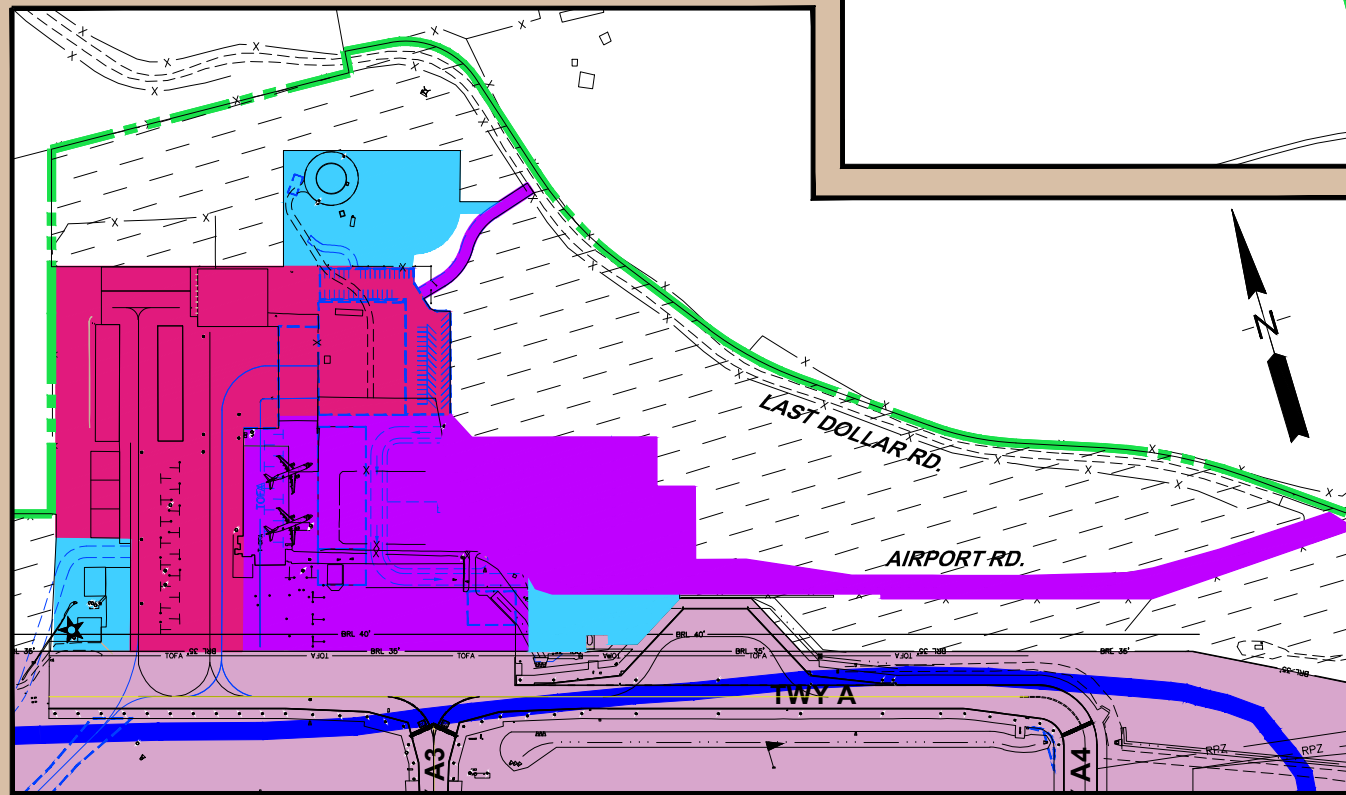
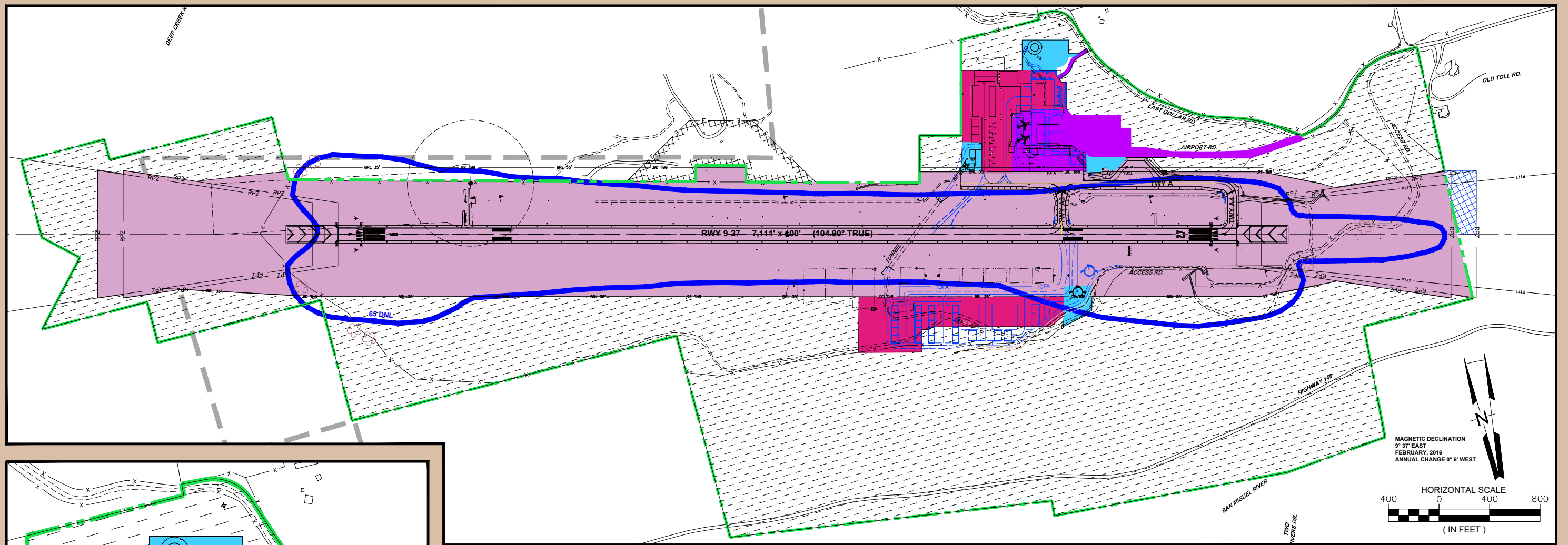

TERMINAL AREA LAND USE PLAN DETAIL

SCALE 1" = 200'

ON AIRPORT LAND USE LEGEND

- SECURED AIRFIELD OPERATIONS AREA
- CORPORATE/GENERAL AVIATION AREA
- COMMERCIAL AVIATION/GA MIXED USE
- SUPPORT FACILITIES
- OPEN SPACE
- 65 NOISE CONTOURS DEVELOPED USING FAA'S AVIATION ENVIRONMENTAL DESIGN TOOL (AEDT)

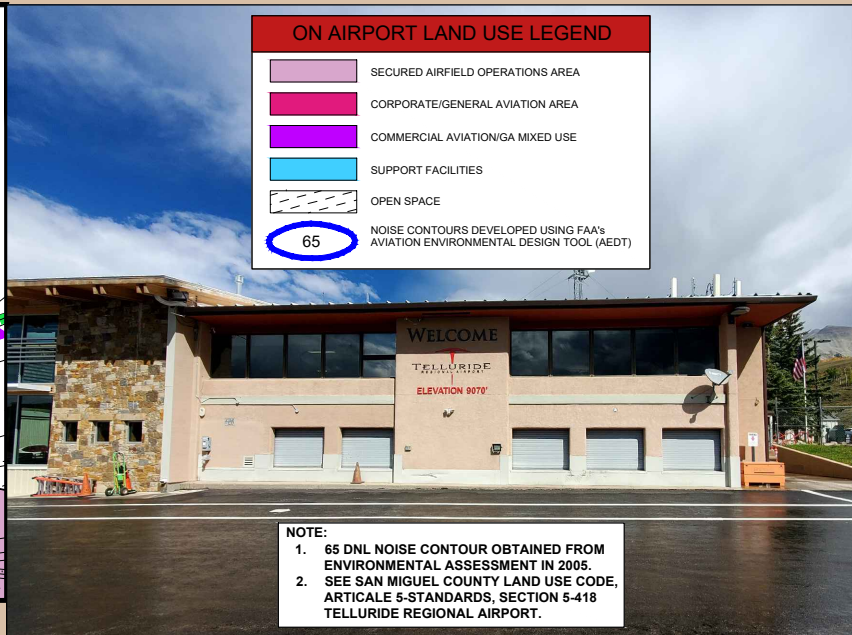

NOTE:
1. 65 DNL NOISE CONTOUR OBTAINED FROM ENVIRONMENTAL ASSESSMENT IN 2005.
2. SEE SAN MIGUEL COUNTY LAND USE CODE, ARTICLE 5-STANDARDS, SECTION 5-418 TELLURIDE REGIONAL AIRPORT.

LEGEND		
	EXISTING	FUTURE
AIRPORT PROPERTY LINE		
EASEMENTS		
AIRFIELD PAVEMENT		
BUILDINGS		
BUILDING RESTRICTION LINES		
NAVAID CRITICAL AREA		
SECTION CORNER		
ROADS AND PARKING AREAS		
GROUND CONTOURS		
PONDS, LAKES, STREAMS, ETC		
FENCE LINE		
AIRPORT BEACON		
AIRPORT REFERENCE POINT		
SEGMENTED CIRCLE & WIND CONE		
SUPPLEMENTAL WIND CONE		
REIL		
PAPI		
POWER POLE		
SURVEY CONTROL POINT		

Jacobs
717 17th. STREET
SUITE 275
DENVER, COLORADO 80202

TELLURIDE
REGIONAL AIRPORT

SPONSOR APPROVAL

TELLURIDE REGIONAL AIRPORT AUTHORITY:
DATED: _____

AIP PROJECT NUMBER:
3-08-0088-038
REV: _____

JACOBS PROJECT NUMBER:
WXYB3300
DATE:
11/01/24

DESIGNED: DCC DRAWN: DCC CHECKED: JP APPROVED: JAR

DRAWING PATHNAME: _____

REFERENCE DRAWING PATHNAME: _____

ISSUE RECORD

NO.	BY	DATE	DESCRIPTION	CKD

FAA CONDITIONAL APPROVAL
SUBJECT TO LETTER DATED: _____
FEDERAL AVIATION ADMINISTRATION
DATED: _____
CASE NO: _____

**ON AIRPORT
LAND USE PLAN**

SHEET 10 OF 12

DRAFT

PROPERTY DATA								
TRACT	ACREAGE	LOCATION	OWNER	FEDERAL PROJECT	DATE	RECORDING INFORMATION	USAGE	INTEREST HELD
1	120.00	PART OF S 1/2 SEC. 30, T43N, R9W, N.M.P.M. PART OF N 1/2 SEC. 31, T43N, R9W, N.M.P.M. PART OF NW 1/4 SEC. 32, T43N, R9W, N.M.P.M. PART OF S 1/2 SEC. 25, T43N, R10W, N.M.P.M.	TELLURIDE REGIONAL AIRPORT AUTHORITY	AIP 3-08-0088-02	6/20/91	BOOK 478, PAGE 1-4 BY CASE 89, CV 59 DISTRICT COURT SAN MIGUEL COUNTY, CO.	RUNWAY, APRON AND TERMINAL BUILDINGS (AERONAUTICAL)	FEE SIMPLE
2	141.94	PART OF S 1/4 SEC. 29, T43N, R9W, N.M.P.M. PART OF S 1/2 SEC. 30, T43N, R9W, N.M.P.M. PART OF N 1/2 SEC. 31, T43N, R9W, N.M.P.M. PART OF NW 1/4 SEC. 32, T43N, R9W, N.M.P.M. PART OF S 1/2 SEC. 25, T43N, R10W, N.M.P.M. PART OF NE 1/4 SEC. 26, T43N, R10W, N.M.P.M.	TELLURIDE REGIONAL AIRPORT AUTHORITY	AIP 3-08-0088-02	5/31/91	BOOK 478, PAGES 975-980 SAN MIGUEL COUNTY, CO.	RUNWAY PROTECTION ZONE (AERONAUTICAL) (AIRPORT DEVELOPMENT)	FEE SIMPLE
5	---	SEE NOTE	---	---	---	---	---	---
6	247.23	PART OF SW 1/4 SEC. 29, T43N, R9W, N.M.P.M. PART OF S 1/2 SEC. 30, T43N, R9W, N.M.P.M. PART OF N 1/2 SEC. 31, T43N, R9W, N.M.P.M. PART OF NW 1/4 SEC. 32, T43N, R9W, N.M.P.M. PART OF S 1/2 SEC. 25, T43N, R10W, N.M.P.M. PART OF NE 1/4 SEC. 26, T43N, R10W, N.M.P.M.	TELLURIDE REGIONAL AIRPORT AUTHORITY	AIP 3-08-0088-16	9/11/03	#367167 SAN MIGUEL COUNTY, CO.	RSA GRADING	FEE SIMPLE
7	1.79	PART OF SW 1/4 SEC. 30, T43N, R9W, N.M.P.M.	TELLURIDE REGIONAL AIRPORT AUTHORITY	AIP 3-08-0088-16	6/18/04	#367167 SAN MIGUEL COUNTY, CO.	RSA EMBANKMENT	EARTHWORK EASEMENT
8	4.96	PART OF SW 1/4 SEC. 30, T43N, R9W, N.M.P.M.	TELLURIDE REGIONAL AIRPORT AUTHORITY	AIP 3-08-0088-16	6/18/04	#367167 SAN MIGUEL COUNTY, CO.	RSA EMBANKMENT	EARTHWORK EASEMENT
9	3.12	PART OF SW 1/4 SEC. 30, T43N, R9W, N.M.P.M.	TELLURIDE REGIONAL AIRPORT AUTHORITY	AIP 3-08-0088-16	6/18/04	#367167 SAN MIGUEL COUNTY, CO.	RSA EMBANKMENT	EARTHWORK EASEMENT
FUTURE PROPERTY DATA								
TRACT	ACREAGE	LOCATION	OWNER	FEDERAL PROJECT	DATE	RECORDING INFORMATION	USAGE	INTEREST HELD
3	10.63	PART OF SW 1/4 SEC. 25, T43N, R10W, N.M.P.M.	U.S. FOREST SERVICE	NONE	1/9/95	PERMIT NO. FS-2700-4 (7-93) OMB 0596-0082	RSA, ROFA, RPZ (AERONAUTICAL)	SPECIAL USE PERMIT EXPIRES 12-31-2014 FUTURE LAND TRANSFER
4	18.18	PART OF SW 1/4 SEC. 25, T43N, R10W, N.M.P.M.	U.S. FOREST SERVICE	NONE	1/9/95	PERMIT NO. FS-2700-4 (7-93) OMB 0596-0082	APPROACH PROTECTION (AERONAUTICAL)	SPECIAL USE PERMIT EXPIRES 12-31-2014 FUTURE LAND TRANSFER
10	2.30	---	MDCM HOMEOWNERS COMPANY	---	---	---	RUNWAY PROTECTION ZONE	EASEMENT RECOMMENDED TO BE ACQUIRED
11	65.32	INCLUDES TRACT 3 AND TRACT 4	U.S. FOREST SERVICE	---	---	---	RSA, ROFA, RPZ	FUTURE LAND TRANSFER

SURVEY MONUMENTS					
IDENTIFIER	NGS PID	PACS OR SACS	LATITUDE	LONGITUDE	ELEVATION
TEX E	DP6610	PACS	37° 57' 13.233"	107° 54' 16.624"	9043.9'
TEX F	DP6611	SACS	37° 57' 22.805"	107° 54' 58.980"	9024.6'
TEX G	DP6612	SACS	37° 57' 07.899"	107° 53' 50.179"	9063.2'

SOURCE: NATIONAL GEODETIC SURVEY, NAD 83 (2011), NAVD 88

LEGEND		
	EXISTING	FUTURE
AIRPORT PROPERTY LINE		
EASEMENTS		
AIRFIELD PAVEMENT		
BUILDINGS		
BUILDING RESTRICTION LINES		
RUNWAY SAFETY AREA		
RUNWAY OBJECT FREE AREA		
RUNWAY PROTECTION ZONE		
TAXIWAY SAFETY AREA		
NAVAID CRITICAL AREA		
SECTION CORNER		
ROADS AND PARKING AREAS		
FENCE LINE		
AIRPORT BEACON		
AIRPORT REFERENCE POINT		
SEGMENTED CIRCLE & WIND CONE		
SUPPLEMENTAL WIND CONE		
REIL		
PAPI		
POWER POLE		
SURVEY CONTROL POINT		

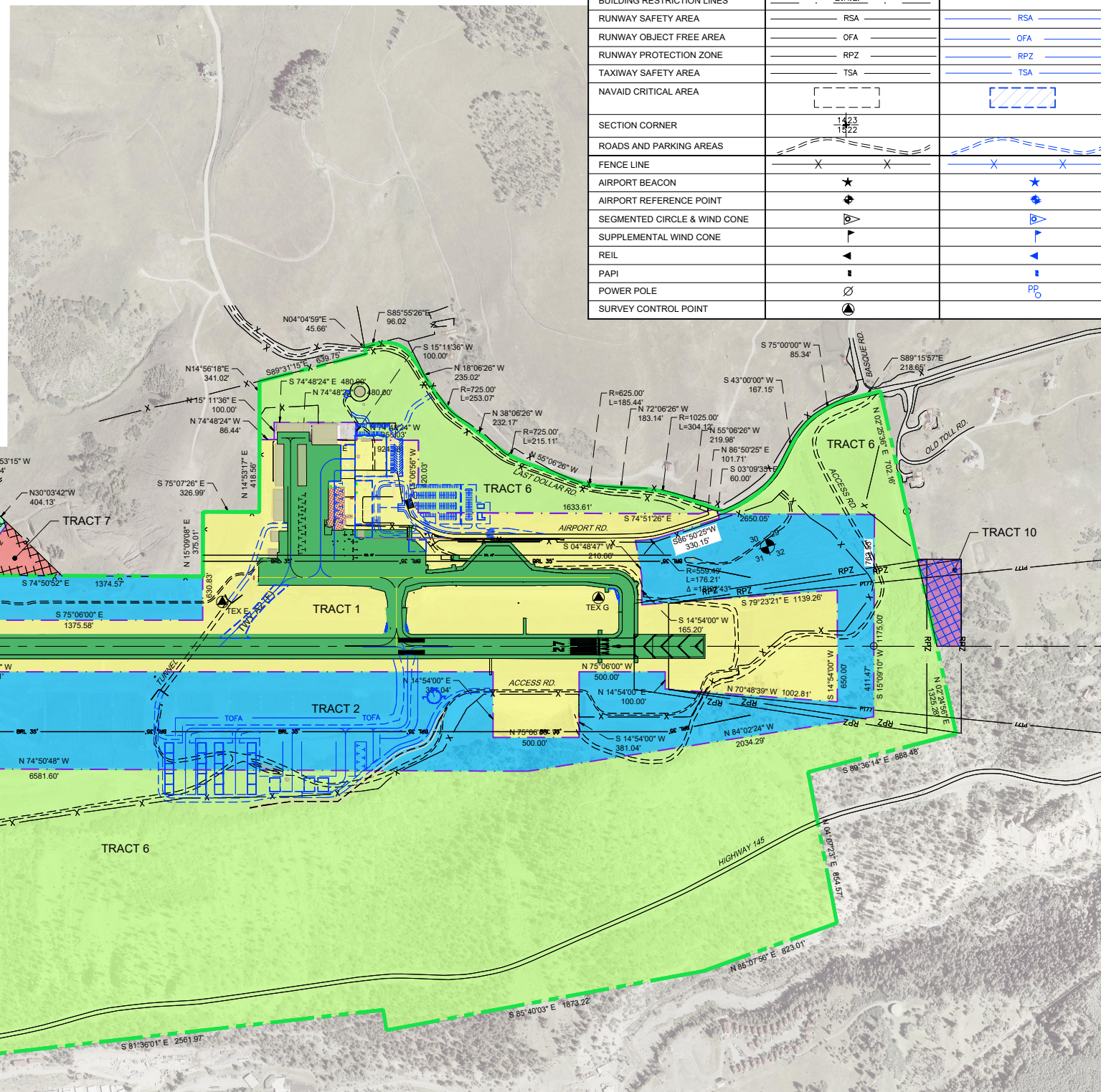

NOTE: TRACT NO. 5 NO LONGER EXISTS AS THE 1.10 ACRES DRAINAGE PIPE EASEMENT HAS BEEN VACATED, TERMINATED AND EXTINGUISHED AS OF 2/16/2012 PER DAC. 423528, PAGE 1, SAN MIGUEL COUNTY.
SOURCE: PROPERTY INFORMATION FROM AIRPORT PROPERTY MAP OF PREVIOUS ALP DATED JUNE 2006.

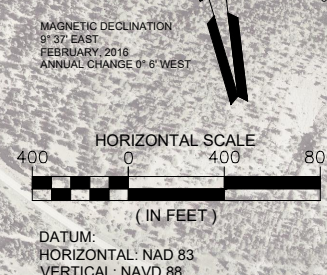

Jacobs
717 17th. STREET
SUITE 275
DENVER, COLORADO 80202

TELLURIDE
REGIONAL AIRPORT

SPONSOR APPROVAL
TELLURIDE REGIONAL AIRPORT AUTHORITY:
DATED: _____

AIP PROJECT NUMBER:
3-08-0088-038
REV.:
JACOBS PROJECT NUMBER:
WXYB3300
DATE:
11/01/24
DESIGNED: DCC
DRAWN: DCC
CHECKED: JP
APPROVED: JAR
DRAWING PATHNAME:
REFERENCE DRAWING PATHNAME:

ISSUE RECORD				
NO.	BY	DATE	DESCRIPTION	CKD

FAA CONDITIONAL APPROVAL
SUBJECT TO LETTER DATED: _____
FEDERAL AVIATION ADMINISTRATION
DATED: _____
CASE NO: _____

AIRPORT PROPERTY MAP
SHEET 11 OF 12
DRAFT

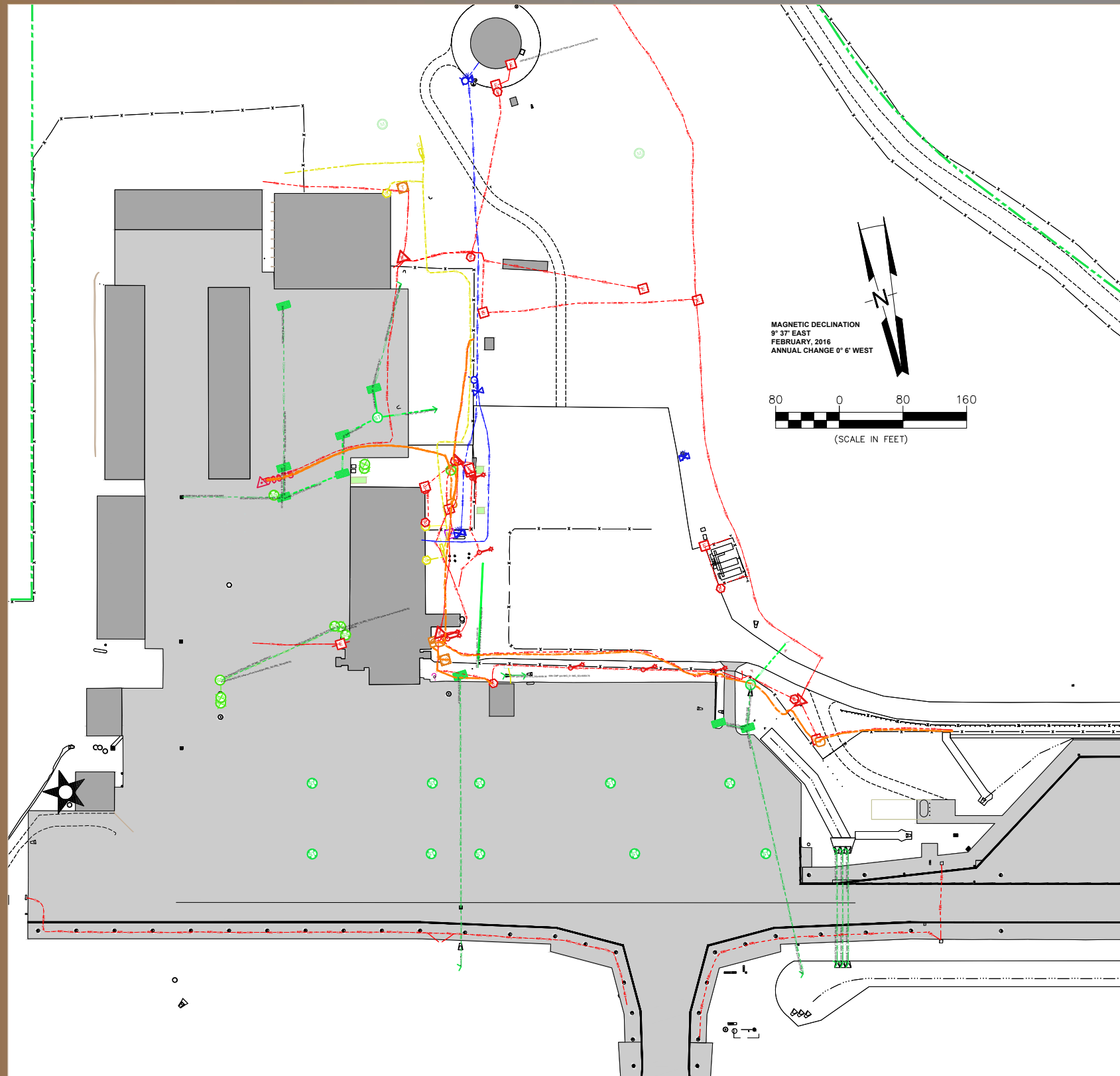

- Notes
- The drawing coordinates are NAD83 (2011) Colorado State Plane, South Zone (0503) based on PACS control point TEX E.
 - Field utility mapping was performed between September 11, 2023 and October 6, 2023. This mapping will not depict changes to utility systems made after completion of field mapping.
 - Existing utility information was collected in accordance with the American Society of Civil Engineers (ASCE) Standard Guideline for the Collection and Depiction of Existing Subsurface Utility Data (CI/ASCE 38-22).
 - Underground utilities were traced using inductive or conductive methods. Ground Penetrating Radar or other geophysical investigation techniques were not utilized to search for non-conductive, abandoned, or other utilities not identified by surface or map evidence. Manholes and vaults were opened and inverts were measured using a dip rod, unless otherwise noted.
 - Potholing to confirm exact size and location of existing facilities is recommended where design and construction is anticipated within 5 feet of the utilities shown.
 - Utility status is not shown on drawings. Design Engineer and Contractor to assume that all utilities are active unless utility owner specifically notifies Design Engineer or Contractor that the utility is abandoned.
 - Subsurface utilities shown meet ASCE 38-22 Quality Level B, unless otherwise noted.
 - Storm and Sanitary sewer lines shown meet ASCE 38-22 Quality Level C, unless otherwise noted.
 - Quality Level D information shown on these drawings are based on utility owner maps.
 - Pipe Elevations shown are Pipe Inverts, unless otherwise noted.
 - Contractor remains responsible for field verifying the horizontal and vertical location of all utilities.

UTILITY LEGEND			
Ⓛ	Electric Box	—	Communication Locate Marking
Ⓜ	Electric Meter	—	Electric Conduit
Ⓞ	Electric outlet	—	Electric Locate Marking
Ⓟ	Electric Pullbox	—	Fiber Optic Locate Marking
Ⓠ	Electric StreetLight	—	Miscellaneous Line
Ⓡ	Electric Transformer	—	Natural Gas Locate Marking
Ⓢ	Environmental Monitoring Well	—	Pavement Concrete
Ⓣ	Fiber Optic Vault Point	—	Sanitary Pipe
Ⓤ	Irrigation Box	—	Storm Drain Channel
Ⓥ	Aircraft Tie Down Loop	—	Storm Drain Chase
Ⓦ	Natural Gas Line Marker Post	—	Storm Drain Inlet
Ⓧ	Natural Gas Meter	—	Storm Drain Pipe
Ⓨ	Sanitary Cleanout	—	Storm Drain Vault Line
Ⓩ	Sanitary Invert	—	Telephone Locate Marking
ⓐ	Sanitary Manhole	—	Water Locate Marking
ⓑ	Storm Drain Cleanout		
ⓓ	Storm Drain Flared End Section		
ⓔ	Storm Drain Grate		
ⓖ	Storm Drain Manhole		
ⓗ	Survey Control Point		
Ⓢ	Telephone Cabinet		
Ⓣ	Telephone Pedestal		
Ⓤ	Telephone Vault Point		
Ⓦ	Terrain Spot Elevation		
Ⓧ	Unknown Utility Access Cover		
Ⓨ	Water Faucet/Hose Bibb		
Ⓩ	Water Fire Hydrant		
ⓐ	Water Valve		

LEGEND	
	EXISTING
AIRPORT PROPERTY LINE	—
EASEMENTS	—
AIRFIELD PAVEMENT	—
BUILDINGS	—
NAVAID CRITICAL AREA	—
SECTION CORNER	—
ROADS AND PARKING AREAS	—
GROUND CONTOURS	—
PONDS, LAKES, STREAMS, ETC	—
FENCE LINE	—
AIRPORT BEACON	★
AIRPORT REFERENCE POINT	Ⓛ
SEGMENTED CIRCLE & WIND CONE	Ⓢ
SUPPLEMENTAL WIND CONE	Ⓣ
REIL	Ⓤ
PAPI	Ⓦ
POWER POLE	Ⓧ
SURVEY CONTROL POINT	Ⓨ



Jacobs
717 17th. STREET
SUITE 275
DENVER, COLORADO 80202

TELLURIDE
REGIONAL AIRPORT

SPONSOR APPROVAL
TELLURIDE REGIONAL AIRPORT AUTHORITY
DATED: _____

AIP PROJECT NUMBER:
3-08-0088-038
REV: _____
JACOBS PROJECT NUMBER:
WXYB3300
DATE:
11/01/24
DESIGNED: DCC
DRAWN: DCC
CHECKED: JP
APPROVED: JAR
DRAWING PATHNAME:
REFERENCE DRAWING PATHNAME:

ISSUE RECORD				
NO.	BY	DATE	DESCRIPTION	CKD

FAA CONDITIONAL APPROVAL
SUBJECT TO LETTER DATED: _____
FEDERAL AVIATION ADMINISTRATION
DATED: _____
CASE NO: _____

UTILITY LAYOUT PLAN
SHEET 12 OF 12
DRAFT